

UK & Ireland

Product Catalogue

2023/24

Edition 1

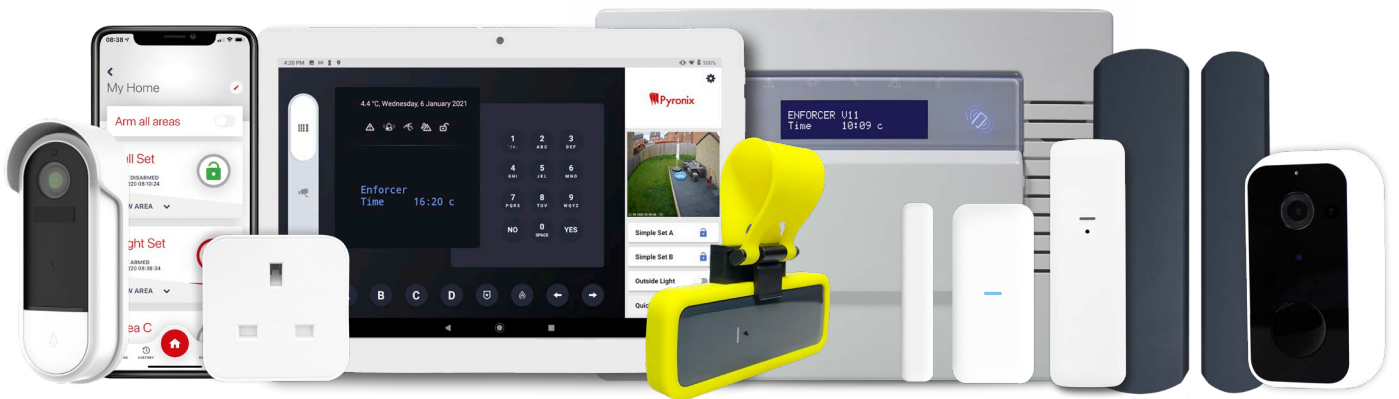

What's New

More options, more flexibility, more value.

DoorbellCam and Chime

Versatile, robust and convenient, the Pyronix HomeControl DoorbellCam is our new outdoor, wirefree doorbell camera that offers main-entrance protection and two-way communication.

The battery-powered doorbell camera comes with Full-HD video, 130 degree wide-angle view, motion detection, real-time notifications and push to talk function.

BatteryCam

Add video surveillance, anywhere with the BatteryCam. Its wireless design allows it to be placed wherever it's required and moved whenever it's needed. Indoor or outdoor, place it or mount it, it's up to you.

With 130° wide-angle view, motion detection, real-time notifications and push-to-talk function, users are always connected to home and able to see exactly what's happening 24/7.

CarDefender

Working in conjunction with existing Pyronix systems, the CarDefender is our combined technology device recommended for vehicle security. With three configurable detection modes, it can be set to trigger for shock only, tilt only, or if either shock or tilt is detected.

MCEXTERNAL-WE

Tough, tamperproof and weatherproof, the MCEXTERNAL-WE wireless outdoor magnetic contact delivers a whole new option to perimeter protection in residential and commercial settings. Engineered for enhanced performance, the MCEXTERNAL-WE can be connected to cameras for voice push notification and video verification capabilities. A simple and quick upsell opportunity for your installation and maintenance visits.

SPEAKER/SOUNDER-WE

Quick-to-fit and fully configurable, the mains-powered wireless SPEAKER/SOUNDER-WE replicates the tones of the control panel to audibly alert users to system activity, while the bright courtesy light illuminates on entry/exit, mains fail and fire and strobes with alarm events. An easy upsell that adds value to any installation.



AndroidTablet and HomeControlHUB app

Provide unprecedented control over the Enforcer V11 security system, with the AndroidTablet and HomeControlHUB app.

Mounted or mobile around any residential or business property, the AndroidTablet allows users to not only surf the web, but open HomeControlHUB to action any keypad function. The interface also combines the Enforcer V11, SmartPlug and cameras to control security, automation and video. It's time to deliver a completely unified customer experience.

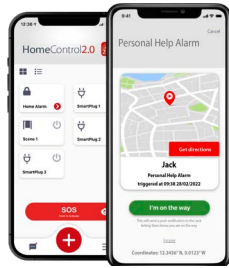

Personal Help Alarm

If ever in a distressing situation, the Personal Help Alarm enables users to raise an alarm by sending an SOS notification to a 'bubble' of family or friends, whether inside or outside the home.

The feature operates on a standalone and subscription free basis, so anyone can use the Personal Help Alarm.

HomeControl2.0 with SmartPlug

Control multiple aspects of the home from a single interface.

Offering unparalleled control over home security and automation, HomeControl2.0 now offers SmartPlug compatibility and quick-action Widgets.

Available now on iOS™ and Android™.

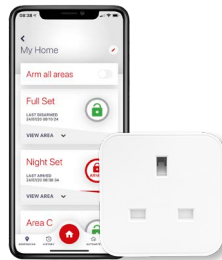

Enforcer V11

Enforcer V11 expands and enhances system application capabilities further than ever before, with Wi-Fi built onboard alongside a range of new and innovative features that practically cover any installation requirements for homes or businesses.

The most advanced Pyronix system released to date delivers real added value with every installation; security, automation and video that can be tailored, controlled, scheduled and delivered for any user preferences. This system is all you need.

NANO/SHOCK-WE

Flexibly fitting out of sight within uPVC window or door frames, the NanoShock is a compact Grade 2 wireless shock sensor that's designed to deliver easy professional setup and reliable protection.



CarDefender

The shock and tilt accelerometer device for vehicle security

Working in conjunction with existing Pyronix systems, the CarDefender is our three-axis accelerometer device recommended for vehicle security. With three configurable detection modes, it can be set to trigger for shock only, tilt only, or if either shock or tilt is detected.

The device comes with a specially designed, brightly-coloured silicone rubber mount, allowing users to strap it to a vehicle's steering wheel for reliability and visual deterrence. Alternatively, the device can be secured with the included 3M tape for a wide variety of use cases.

Pioneering vehicle intrusion detection



for more information

Personal Help Alarm

Protecting people with HomeControl2.0's new functionality, the Personal Help Alarm

Pressing the SOS button in HomeControl2.0 sends an instant push notification to a user's contact bubble, alerting to distress and sharing their geolocation.

Recipients can then take action, opening Google or Apple maps to quickly locate and come to their aid.

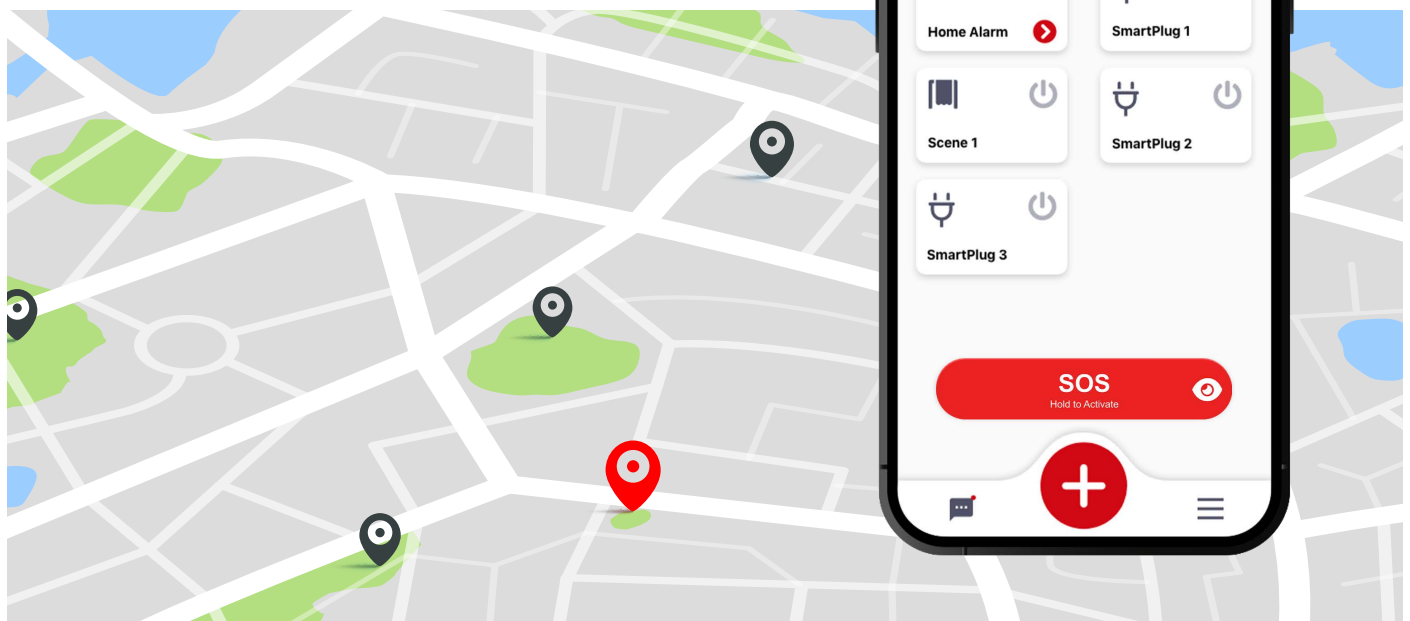

SmartPlug

Enter the smart home market with the SmartPlug

Add greater upsell opportunities to your product offering and deliver value-added integration with the SmartPlug.

Make your users lives easier by automating, activating and switching devices on and off via the Android/Apple with HomeControlHUB app. You can even create scenes to deliver the exact functions your customers want. Embrace the potential.

HomeControl2.0

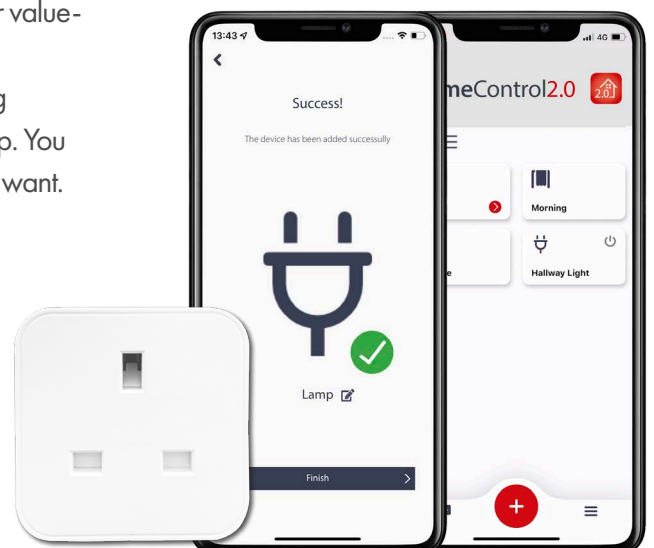

HomeControl DoorbellCam

Monitor, view and speak to visitors at any time, from anywhere

Versatile, robust and convenient, the Pyronix HomeControl DoorbellCam is our new outdoor, wire-free doorbell camera that offers main-entrance protection and two-way communication.

The battery-powered doorbell camera comes with Full-HD video, 130 degree wide-angle view, motion detection, real-time notifications and push to talk function. With these helpful features, users are able to see exactly what's happening on the doorstep and can answer the door, even when they're not there.

Open the door to new sales opportunities with the Pyronix DoorbellCam.

Stay connected to home

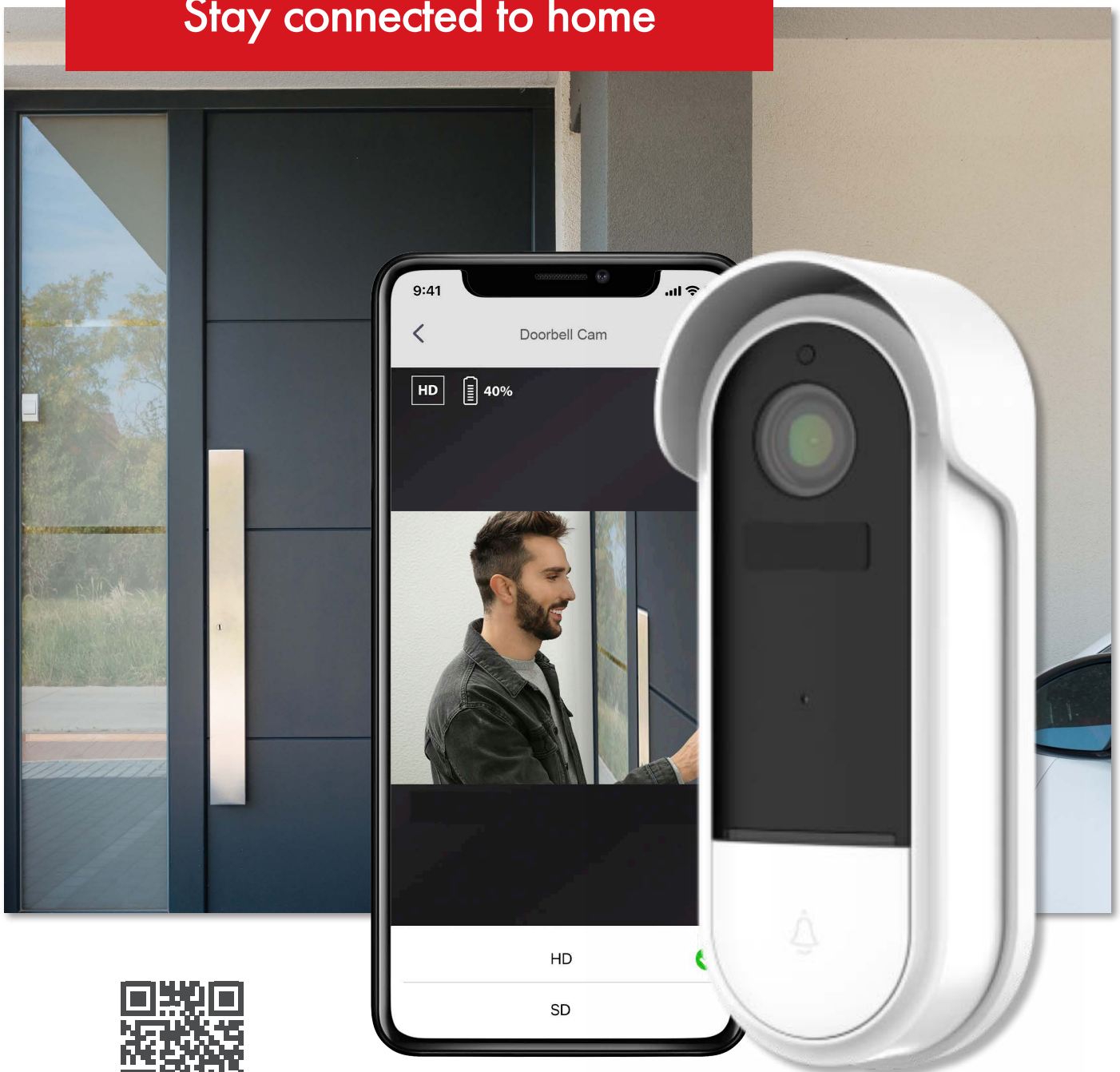

for more information

Extending the capabilities of security control

Built on a new and intuitive interface, HomeControl2.0 makes security easy, convenient and simple for both you and your users, while delivering extensive protection and peace of mind.

With new features such as geofence alerts and biometric login, HomeControl2.0 offers a completely new level of monitoring, control, interactivity and a great upselling opportunity.



Geofence alerts

Arming/disarming reminders programmable from 100m to 1000m away from the property.



Great new look and feel

Makes controlling and managing the alarm system fast and easy.



Biometric login

Logging into the system has never been easier or simpler.

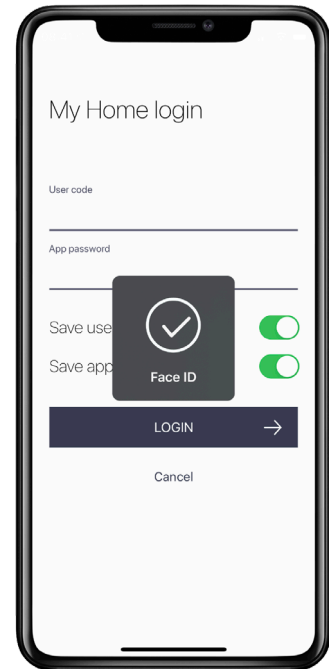
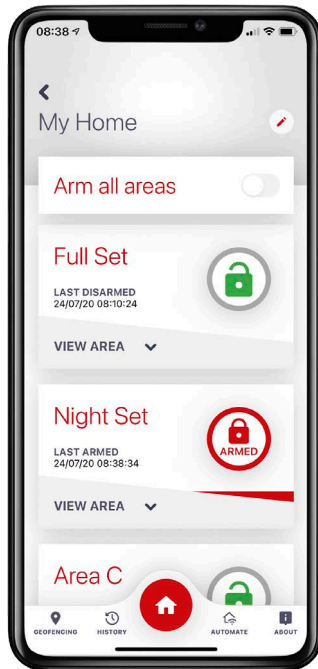
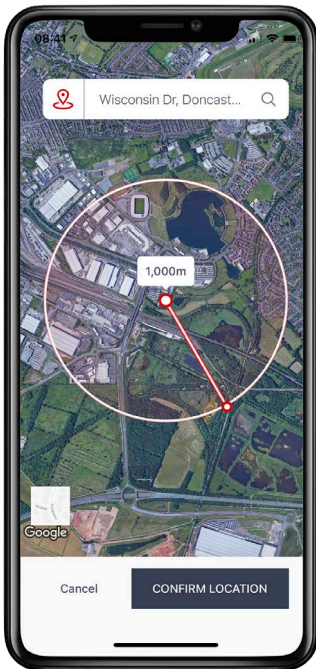

Make managing and controlling the security system fast and efficient with an enhanced interface that puts the user at its heart. Delivering an enhanced user experience, HomeControl2.0 is designed to evolve so that you're providing the alarm-only solution for now and the fully-integrated platform of the future.



Find out more

Your portable command centre

Taking security control to new levels with the AndroidTablet and HomeControlHUB app.

Provide unprecedented control over the Enforcer V11 security system, with the AndroidTablet and HomeControlHUB app.

Mounted or mobile around any residential or business property, the AndroidTablet allows users to not only surf the web, but open HomeControlHUB to action any keypad function. The interface also combines the Enforcer V11, SmartPlug and cameras to control security, automation and video. It's time to deliver a completely unified customer experience.

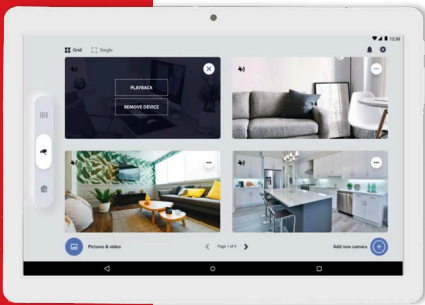

See. Act.

View cameras through HomeControlHUB by connecting your ProControl+ or Hik-Connect accounts to bring a complete video solution into one platform. The user can view up to 16 cameras through HomeControlHUB on the AndroidTablet. This delivers total awareness of the property, while fusing video and security into one platform simplifies the installation and provides a convenient, single user experience. Let users see what's happening and give them the power to act. Video and security in one.

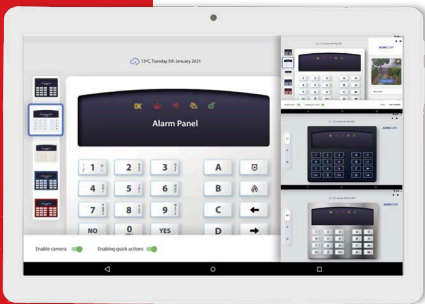

Making maintenance a dream

The AndroidTablet with HomeControlHUB isn't just a convenient interface for the user to take around their property, but also for you, as a portable keypad for your maintenance visits. Don't waste time referring back to a static keypad on the wall, pick up the AndroidTablet and walk around the property to quickly and efficiently check, diagnose and maintain the system. Maintenance is on the move.

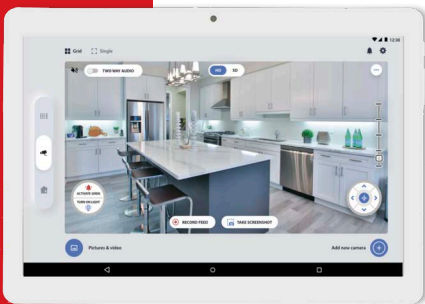

Sound the alarm!

At the touch of the AndroidTablet's screen, HomeControlHUB lets the user activate loud, audible sirens that sound for 15 seconds to scare potential intruders off. So, should the user see something suspicious through their cameras, they can proactively take direct action to stop any intruders in their tracks. Something wrong, activate the alarm.

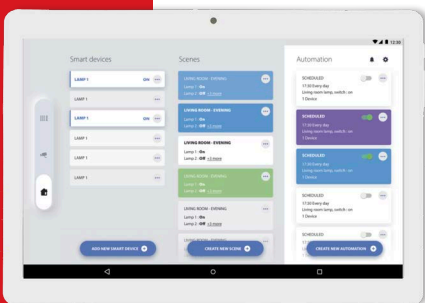

Plug in to the potential

The introduction of the SmartPlug adds even greater upsell opportunities; entering the smart home market with value-added integration. Automate devices to activate at times, create scenes that activate at the touch of a button, or simply switch devices on and off. Embrace the potential.

Please note: The AndroidTablet and HomeControlHUB app can only be used to control the security system when connected to the same Wi-Fi router. When connected to a different router, only automation and video functions can be controlled.



App compatibility

Keeping your users connected and in control

App connectivity enables users to control and manage their alarm system from one simple-to-use interface. Deliver the perfect solution to suit the needs and preferences of your customers with Pyronix.

We recommend the use of our HomeControl2.0 app for system management outside of the home and, when connected to the same wireless network as the Enforcer V11 wireless control panel, our AndroidTablet offers a seamless interface for our HomeControlHUB.



Alarm

We offer a wide variety of app-connected control panels for you to choose from, allowing you to tailor your systems for each and every residential or commercial application. Pick from our diverse range of wired and wireless detectors, contacts, sirens, life safety sensors and more to create the perfect solution for your customers.



Automation

Provide even greater control over the home with automation devices, like the SmartPlug. You, and your users, can enable on/off control of devices, configure scenes and automations, and monitor energy consumption via our apps. Third-party automation devices can even be wired into our control panels and triggered to operate lighting or gates, for example.

Add greater selling and upselling opportunities to your systems with Pyronix.



Video

The LightCamera, or any Hikvision video device, can be installed to provide users with live-stream video and recording function, giving them the visual confirmation they need to verify any alarm activity. The LightCamera can be fitted as a standalone solution or integrated within the system to illuminate the property and deter intruders with its ultrabright lights, built-in siren and two-way talk.

*HomeControl2.0 coming soon





HomeControl2.0

Make managing and controlling Enforcer V11 and EURO 46 V10 security systems faster and more efficient with HomeControl2.0.

HomeControl2.0 offers unparalleled control over home security, delivering features such as geofence arming and disarming alerts and enhanced biometric login. The app allows users to view up to 10 panel events and up to 50 app notification logs, keeping them constantly up-to-date with their home security. Users also benefit from a host of product compatibilities, including the SmartPlug, DoorbellCam, and Personal Help Alarm.



Alarm



Video



Automation



AndroidTablet with HomeControlHUB

The AndroidTablet offers a seamless interface for our HomeControlHUB app when connected to the same wireless network as the installed control panel. Mounted or mobile, the AndroidTablet allows users to control security settings and action keypad functions, view camera systems, control home automation devices, as well as the ability to surf the web and download apps. The interface smoothly combines with the Enforcer V11 system, and any of its installed cameras, to control security, video and automation.

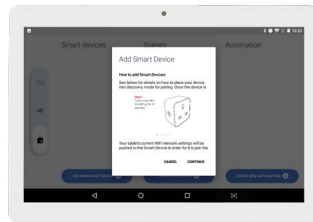
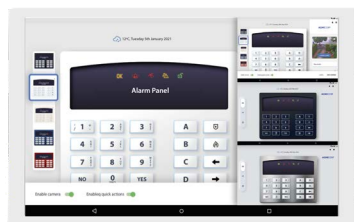
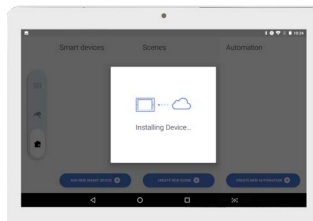
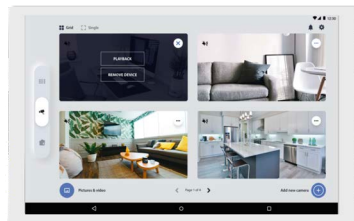

Alarm



Video



Automation



ProControl+

ProControl+ can provide users with a standalone security or video system, as well as a fully integrated solution. Using both the Enforcer V11 or EURO 46 V10 control panels, as well as the LightCamera and any Hikvision video device.

Users can view and monitor their system status, as well as arm, disarm, control outputs, receive push and voice push notifications. They can also receive a push notification for video verification of events and view up to 16 camera live streams simultaneously.



Alarm



Video

COMING
SOON

InSite Pro Tools

The next generation of PyronixCloud and InSite;
all together in one place.

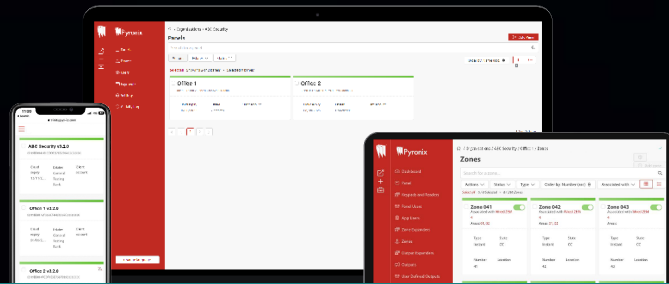

The next generation of security technology

InSite 
ProCloud

The new platform for all of your cloud settings, including panel configuration and app user pages.

Remotely program your panels, diagnose, and solve issues, without any need to upload settings offline and send back to the panel.

InSite 
ProLocal

Configure panel settings quickly and easily on-site.

InSite Pro Local is the new web browser interface we've built into our Enforcer X 280 control panel to help make installation and set-up a breeze.

**COMING
SOON**

Enforcer X 280

A whole new experience in commercial and large-residential security.

Introducing our newest, app-connected panel.

With 99 areas and 4 levels per area, the Enforcer X 280 has been developed to deliver a whole new experience in commercial and large-residential security solutions for installers and integrators.



App connectivity



Zone Scan



Over-the-Air



BUS Scan

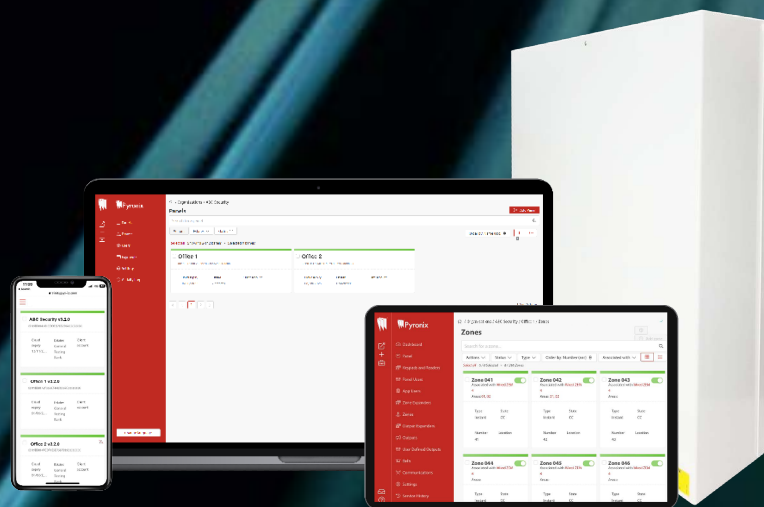

For more information go to page 22

PyronixCloud

Online system gateway and recurring revenue platform.

Acting as the online administration software for Pyronix IP systems, PyronixCloud is a gateway for managing your estate of control panels. From here, you can manage app users, push notifications, and recurring revenue streams. PyronixCloud also acts as the security gateway between the HomeControl2.0, HomeControlHUB and ProControl+ apps and other applications like InSite; authenticating connections to maintain maximum security.



Remote diagnostics and control

PyronixCloud allows the remote programming and diagnosis of systems using our InSite UDL software. This saves time, money and increases the number of installations that can be completed.



High security encryption

With PyronixCloud maximum security is maintained, with all communications encrypted to the same accepted level of standard encryption as some banking and government institutions, with no sensitive user data stored on the cloud.



Increase profitability

Streams of recurring revenue can be established by offering PyronixCloud management services; with either yourself managing this or passing access to users. The ongoing use of the smart device apps increases customer retention and makes the system more profitable.



Reliability

PyronixCloud monitors the presence of the Enforcer and EURO systems through polling, over secure IP communications. The polling frequency can be changed in PyronixCloud depending on the network quality.



App customisation

With PyronixCloud, you can add your logo to the home screen of your HomeControl2.0, HomeControlHUB and ProControl+ apps; enhancing your users' experience by delivering a professional, uniquely branded finish.



Push notifications

Using PyronixCloud infrastructure enables the customisation of the push and voice push notifications that each HomeControl2.0 and ProControl+ user receives, when certain events occur on the system.



No complicated port forwarding

By connecting through the cloud server, there is no on-site setup of static IP addresses or configuration of network connection. Instead you simply set up an account on PyronixCloud.com.

ProControl+

Remote control and peace of mind from anywhere.

Voice push notifications

If there is any activity on the system, the user will be alerted with a voice push notification; keeping them informed and allowing them to take appropriate action.

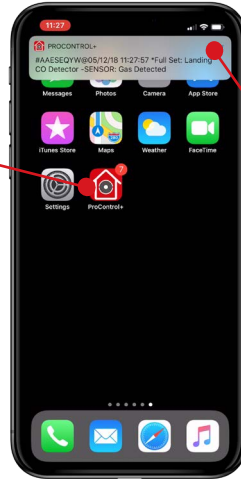

Push notifications

Users can receive push notifications to their smart device to let them know of any activity on the system. In the event of an alarm activation it will even provide sensor details.

Control outputs

Third-party automation devices can be wired into the control panel and triggered with ProControl+ to operate gates or lighting, for example.

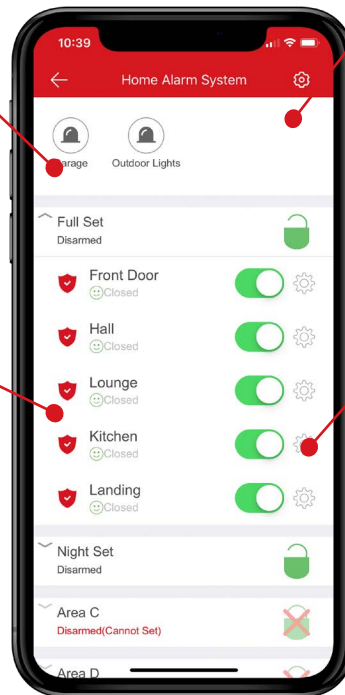

Multi-site

With ProControl+, multiple systems can be added, controlled and monitored from the same application.

Control from anywhere

No matter where the user is they can log in to ProControl+ to control and monitor their security, video or both, at any time.

One app to control all

ProControl+ is the ultimate smart device application for providing users with total peace of mind over their properties. It can function as a standalone security or video system, or as one fully integrated solution; utilising the Enforcer V11 or EURO 46 V10 control panels, with the LightCamera, as well as any Hikvision video device.

Video verification

The user will receive a push notification with a video clip for quick video verification of events.



Split-screen viewing

With a single touch, the live screen view can be changed from observing 1 camera stream to 4, 9, 12 or 16 simultaneously.

Live and recorded

Users have the ability to watch live video, record on an SD-card*, take screenshots, as well as listen in or speak using the LightCamera's two-way talk feature.

*SD card not included.



InSite

Remote maintenance software

Enabling authorised remote access to Enforcer and EURO control panels, to monitor alarm events, diagnose potential faults and view the entire electrical status of the system. You can verify the functionality of your user's security systems for complete confidence and peace of mind.



Remote programming and diagnostics with InSite UDL

Providing authorised users with remote access to the alarm control panel, with the ability to monitor alarm events, diagnose potential faults and view the entire electrical status of the system. If alterations are needed, there is no need to send an engineer; this can be done via InSite. This maintains a more efficient and cost-effective service; minimising site visits by performing maintenance and diagnostics from the office.



Remote and local

With InSite UDL software, you can carry out both remote and local programming, maintenance and diagnostics. This is particularly useful on large-scale systems, whereby you can pinpoint any issues to maximise efficiency of the system, as well as any necessary site visits.



Multiple communication paths

InSite UDL can connect to the Enforcer or EURO control panels locally via RS232 or via the PyronixCloud infrastructure using the GPRS, LAN or Wi-Fi modems.



Automatic remote maintenance and diagnostics

InSite provides you with the ability to make alterations, as well as access a full database of every client, including their complete system configuration, and much more. Systems can even be scheduled to automatically perform one of the compulsory twice-yearly maintenance calls via InSite; recording the result and comparing with initial readings.



Real-time wireless diagnostics

In addition to the built-in wireless diagnostics in both detectors and panels, InSite can be used to position the sensors in the best location by using its real-time wireless diagnostics.



www.pyronix.co.uk

As with all Pyronix products, InSite is backed up with the full support of our technical team. Detailed manuals are provided on disk and full on-screen help is provided as standard, to assist you through programming, alongside step-by-step diagrams.



Available in white
and black housing

LightCamera

Putting security in the spotlight
Illuminating and verifying, with the power to act

Light up dark spots and ward off potential intrusion by adding another layer of perimeter protection, the LightCamera.

Easy-to-fit and simple-to-use, the LightCamera provides powerful Full-HD performance, ultra-bright lights and active defence capabilities, to deliver a new level of interactivity and value to Pyronix systems.



Pair with the XDL12TT-WE or MCEXTERNAL-WE for advanced video verification of events.



Don't just verify, act.
See it in action now!

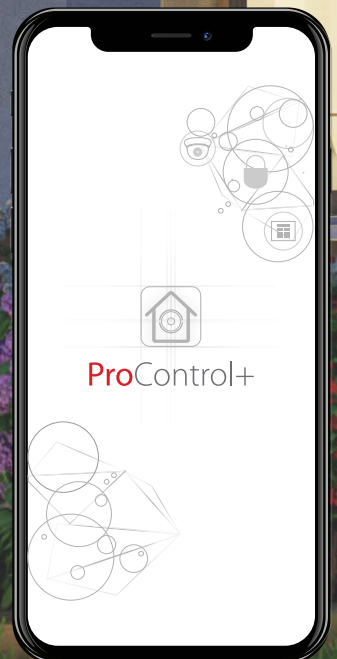

LightCamera

High definition video

The LightCamera delivers Full-HD video via live view and playback through the user's home Wi-Fi network via the ProControl+ smart device application or HomeControlHUB app on the AndroidTablet.

Crystal clear video, even in complete darkness

Changing light conditions are no match, with the LightCamera automatically switching between day and night mode for optimum coverage even on the darkest of nights. Meanwhile, 3D DNR (3D Digital Noise Reduction) reduces the noise effect in low light to deliver clear Full-HD images up to 18m.

Pinpoint protection of what matters most

Fully customise detection areas, alarm responses and motion sensitivity, to deliver the exact level of protection and notifications required.

Illuminate any potential intrusion

The LightCamera has a 270° PIR sensor along with dual lights that produce a powerful combined brightness of 2500 lumens, to put any intruder in the spotlight.

Security and video on demand, from anywhere

Using ProControl+, users can access the LightCamera from anywhere via their smart device. If combined with outdoor detectors, the LightCamera can deliver voice push and video verification clips; allowing users to take action by sounding the siren or speaking through two-way talk. Notification schedules can also be configured to suit the user's lifestyle.

Built to last and perform

The LightCamera boasts an IP65 weatherproof rating, making it dust tight and capable of withstanding severe weather conditions, including projected water.

Local recording with SD card compatibility*

The LightCamera supports MicroSD cards up to 128GB for constant video recording. This allows the user to view footage from any time of day by simply scrolling their finger across the playback timeline to the required time. It won't miss a thing.

*SD card not provided.



for more information

LightCamera

Camera colours and partcodes	
LIGHT-CAM/wht	✓
LIGHT-CAM/blk	✓
Camera specifications	
Resolution	1080p
Field of view	140° (Diagonal), 115° (Horizontal)
Max. resolution	1920 x 1080p (25fps)
Frame rate	50Hz@25fps, Adaptive frame rate of network transmission
Video compression	H.264
IR range	Up to 18m
Backlight compensation (BLC)	✓
DNR	3D DNR
Motion detection (by camera)	✓
PIR Sensor parameters	
PIR motion detection distance	✓
PIR detection distance	✓
PIR detection distance	9m
PIR detection range	270°
Light parameters	
Lights	2
LED	SMD LED
Brightness	2500LM (-10%)
Other technical specifications	
Audio input & output	Built-in omni-direction microphone
Audio output	Built-in loudspeaker
Local storage	Support Micro SD card (Up to 128GB)
Siren	100-decibel alarm
Network parameters	
Wireless	Wireless 802.11 b/g/n @2.4GHz only (2T2R, Dual-antenna)
Network configuration	Soft AP configuration
Minimum network requirement	2.0 Mbps
Environmental and operating feature	
Operating conditions	-30°C to +50°C
Power supply	Hardwired (110V - 240V)
Power consumption	≤2W (normal), ≤8W (max)
Dimensions (W x H x D)	196mm x 211 mm x 277mm
Weight	1757g
Certifications and warranty	
Electrical conformity	CE
Warranty	1 year

HomeControl DoorbellCam



Monitor, view and speak to visitors at any time, from anywhere.

Versatile, robust and convenient, the Pyronix HomeControl DoorbellCam is our new outdoor, wire-free doorbell camera that offers main-entrance protection and two-way communication.

The battery-powered doorbell camera comes with Full-HD video, 130 degree wide-angle view, motion detection, real-time notifications and push to talk function. With these helpful features, users are able to see exactly what's happening on the doorstep and can answer the door, even when they're not there.

Open the door to new sales opportunities with the Pyronix DoorbellCam.

Partcode		DOORBELL/CAM
Camera		
Image Sensor	1/2.9" 2Megapixel CMOS	
Effective Pixels	1920(H) x 1080(V)	
Shutter	1/15~1/10,000s	
Min. Illumination	Color 0.1Lux@F2.0, Black/White 0.01Lux@F2.0	
IR Distance	Night visibility up to 10m	
Day/Night	Auto(ICR)/Colour/B&W	
WDR	DWDR	
Lens & FOV(D)	3.2mm@F2.0,130°	
Video & Audio		
Compression	H.264	
Bit Rate	32Kbps~2Mbps	
Frame Rate	1~25fps	
Dual Stream	Yes	
Audio Input/Output	Built-in mic/speaker	
Network		
Alarm Trigger	Button triggering, PIR detection	
Wireless Security	64/128-bit WPA/WPA2, WPA-PSK/WPA2-PSK, WPS	
Communication Protocol	HTTP, DHCP, DNS, TCP/IP	
Interface Protocol	Private	
Wireless	2.4G Wi-Fi (IEEE802.11b/g/n)	
Mobile Phone OS	iOS 9 or later, Android 7 or later	
Security	AES128	
Max. User Access	4	
Battery & PIR		
Capacity	6700mAh rechargeable Li batteries	
Stand-by Current	200-800 µA (average)	
Working Current	150-200 mA (IR off)	
Stand-by Time	upto 10 months	
Working Time	3 months (10 times wake up per day)	
PIR Detection Range	Max. 5m	
PIR Angle	100°	
General		
Operating Temperature	-20 °C to 50 °C	
IP Rating	IP65	
Power Supply	DC 5V/1A, AC 12~24V	
Power Consumption	Max. 2W	
Storage	SD card(Max.128GB)	
Optional Accessory	Wireless Chime	
Dimensions	57 x 41 x 145 mm	
Net Weight	200g	

DoorbellChime



Partcode		DOORBELL/CHIME
General		
Power	3 x AA LR6 1.5V batteries	
Reset	Support	
Ringtone	4 optional melodies	
Volume	Adjustable	
Frequency	433/868/915MHz	
Transmission Distance	Max. 100m (No obstacle)	
Dimensions	75 x 75 x 32mm	
Weight	80g	

BatteryCam



Indoor and outdoor video monitoring

Add video surveillance, anywhere with the BatteryCam. Its wireless design allows it to be placed wherever it's required and moved whenever it's needed. Indoor or outdoor, place it or mount it, it's up to you*.

With 130° wide-angle view, motion detection, real-time notifications and push-to-talk function, users are always connected to home and able to see exactly what's happening 24/7.

What's more, the BatteryCam connects with our SolarPanel for continuous charge, so it'll never run out of power, and adding our 32GB SD Card allows users to record up to a few-thousand one minute video clips in local storage!

*Device must be located within Wi-Fi range to

Partcode	BATTERY/CAM
Camera	
Image Sensor	1/2.9" 2Megapixel CMOS
Effective Pixels	1920(H) x 1080(V)
Shutter	1/15~1/10,000s
Min. Illumination	Colour 0.1Lux@F2.0, Black/White 0.01Lux@F2.0
IR Distance	Night visibility up to 10m
Day/Night	Auto(ICR)/Color/B&W
WDR	DWDR
Lens&FOV (H/V/D)	3.2mm@F2.0, 106°/57°/130°
Video & Audio	
Compression	H.264
Bit Rate	32Kbps~2Mbps
Frame Rate	1~25fps
Dual Stream	Yes
Audio Input/Output	Built-in mic/speaker
Network	
Alarm Trigger	PIR human-body detection
Wireless Security	64/128-bit WPA/WPA2, WPA-PSK/WPA2-PSK, WPS
Communication Protocol	HTTP, DHCP, DNS, TCP/IP
Interface Protocol	Private
Wireless	2.4G Wi-Fi (IEEE802.11b/g/n)
Security	AES128
Battery & PIR	
Capacity	9600mAh rechargeable Li batteries
Stand-by Current	200-800 μ A (average)
Working Current	150-200 mA (IR off)
PIR Detection Range	Max. 9m
PIR Angle	120°
General	
Operating Temperature	-20 °C to 50 °C
IP Rating	IP65
Power Supply	DC 5V/1A
Power Consumption	Max. 2W
Optional Accessory	SolarPanel
Installation	Magnetic bracket included
Storage	SD card (Max.128GB), Cloud storage
Dimensions Camera	57 x 100 x 57mm
Stand	67 x 50 x 24mm
Net Weight	310g

SolarPanel



Partcode	SOLARPANEL
General	
Maximum power (Pmax)	5W
Tolerance	\pm 3%
Maximum power voltage (Vmp)	5.3V
Maximum power current (Imp)	0.83A
Working temperature	-20°C to 50°C
IP rating	IP65
Cable length	3m
Dimensions - Panel	178 x 228 x 12mm
- Stand	60 x 90mm \varnothing
Net weight	305g

SmartPlug

Enter the smart home market with the SmartPlug

Add greater upsell opportunities to your product offering and deliver value-added integration with the SmartPlug.

Make your users lives easier by automating, activating and switching devices on and off via the AndroidTablet with HomeControlHUB app. You can even create scenes to deliver the exact functions your customers want. Embrace the potential.



Partcode	SMARTPLUG
SmartPlug	
Key features	
HomeControlHUB compatible	✓
Casing material	PC+ABS, fire-proof level V0
Indicator LED	Blue
Electrical specifications	
Input voltage	100 - 240VAC
Input frequency	50/60Hz
Maximum load	13A, 2990W general use
Wireless specifications	
Wi-Fi standards	802.11 b/g/n
Wi-Fi frequency	2.4GHz
Temperature	
Operating	-20°C to 50°C
Storage	-40°C to 80°C
Dimensions (W x H x D) and weight	
Dimensions	58 x 58 x 39mm (excluding pins)
Weight	85g
Certifications	
Electrical conformity	CE
Other	ROHS

Enforcer V11



"Intruder Product of the Year"



The most advanced Pyronix system released to date, the Enforcer V11 is fully EN50131 and PD6662 approved for any Grade 2 installation, while delivering security, automation and video for any user preferences.

Enforcer

System architecture

Using the entire Pyronix range of peripherals, you can tailor the ideal Enforcer system for any fully-wireless or hybrid installation requirements.

• • • • • Wireless

Award-winning Enforcer two-way wireless intruder alarm products provide you with quick-to-fit, effective solutions that maximise installation efficiency and are easy for your users to operate.

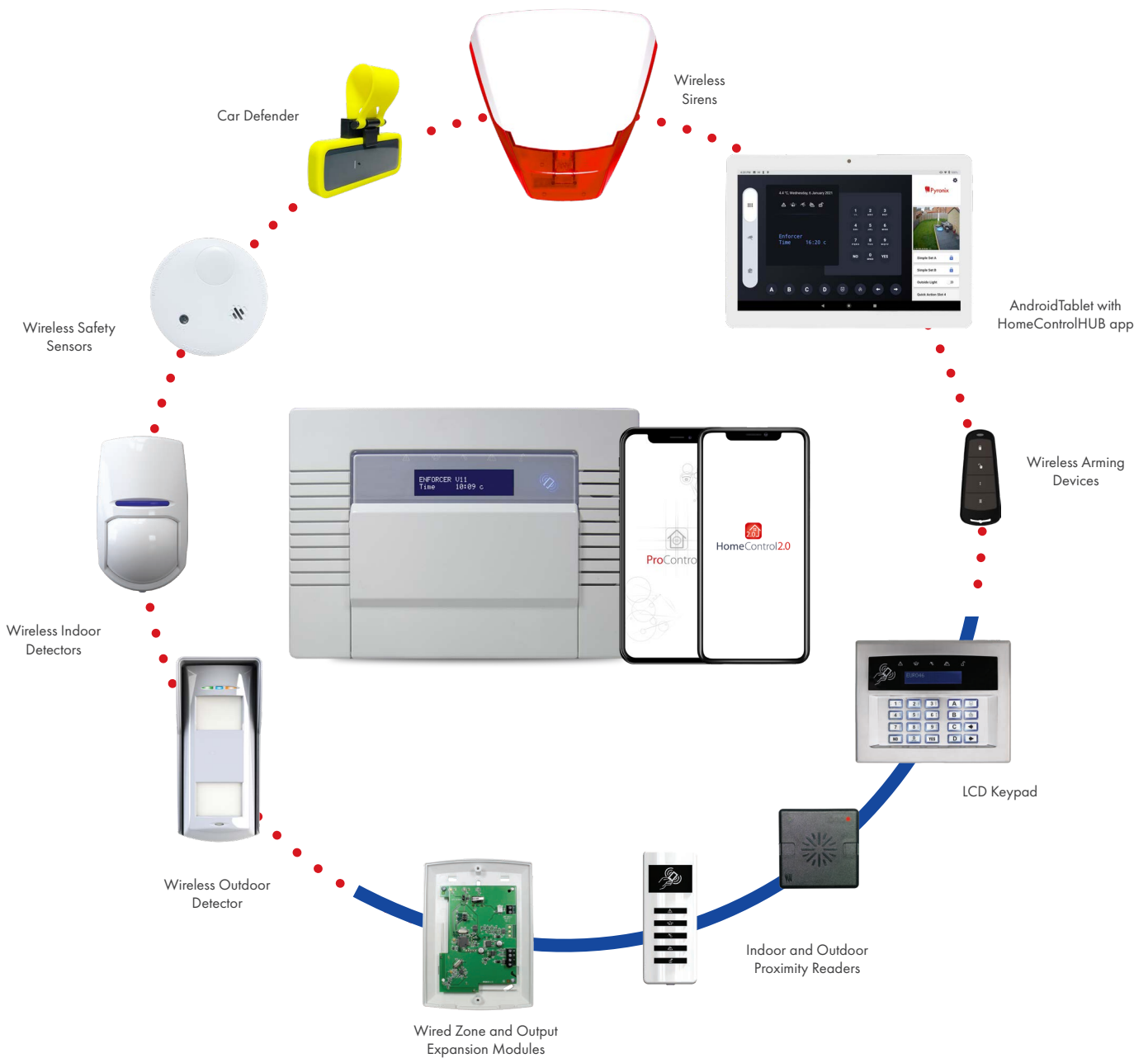

— Wired

Zone and output expansion modules can be added via the RS485 communication bus; delivering hybrid capabilities to add wired peripherals as required, such as keypads, proximity card readers and more.



Enforcer V11

Multiple communications. You're covered.

With Wi-Fi communications now built onboard the main Enforcer PCB as standard, the Enforcer V11 delivers Pyronix app compatibility straight out of the box; quickly and efficiently connecting to the user's existing router. Additional communication paths can be added for simultaneous messaging to both the app and an Alarm Receiving Centre (ARC) via separate paths; maximising coverage for total peace of mind. That's communications covered.

With the push of a button

The installation of the Enforcer V11 has been enhanced by the addition of a WPS button. By pairing the Enforcer V11 with the router with a push of the WPS button, valuable time is saved; maximising efficiency and convenience. One press, it's as easy as that.

Unsupervised zones for cars, vans and caravans

Delivering unprecedented security coverage, unsupervised zones can be set up to add security peripherals on cars, vans and caravans. Provide additional peace of mind to what's parked outside the property, without risking supervision faults when they're parked away. Extend the security, expand the system.

Timed activity for total reassurance

Give users the confidence to maintain independent living, by setting timers to generate a specific response if no movement has been detected by using occupancy zones and times. Responses include sending a push notification to a loved one via the app, or even notifying an ARC. Install a system that cares.

Take control with the AndroidTablet and HomeControlHUB

Deliver a completely unified customer experience, with the AndroidTablet and HomeControlHUB app. Fusing the Enforcer V11, SmartPlug and cameras into one, users can surf the web, as well as control security, automation and video. Find out more by scanning the QR code below and take control to new levels.

Interlinking Smokes and Heat

This new feature enables our Smoke and Heat sensors to interlink, meaning all detectors in a property will sound at once with activation.

Having interlinking Smoke and Heat sensors is a legal requirement in Scotland, so this latest update will ensure compliance for our Scottish installers.

It is conceivable the rest of the UK will adopt interlinking Smoke and Heat sensors as a legal requirement, therefore, this update also future-proofs the system for any possible changes in law.

The update benefits end-users too, alerting them to life-safety scenarios through their panel and connected Pyronix apps. A huge advantage to this is, unlike standard interlinking solutions, Pyronix end-users will receive notification directly to their smart device, no matter where they are in the world, allowing them to take action as necessary.

*Smoke and Heat sensors with the latest software (version V4.00) are required.

Partcode	Enforcer V11
Key features	
Onboard/maximum zones	32/66
Onboard/maximum outputs	3/38
Areas (independent or level)	4
Arm/disarm methods	App, pin, prox or keyfob
User codes	80
- Guard/duress	2
System logs	750
Programmable automation types	30
Wireless devices (requires ZEM32-WE*)	
Onboard/maximum* zones	32/64
Keyfobs	32
Arming stations	4
Bells	2
Wired devices	
Onboard/maximum zones	2/34
Onboard/maximum outputs	3/38
Maximum keypads	4 (including onboard)
Maximum readers	4 (including onboard)
Communication	
Module compatibility	DIGI-LAN, DIGI-GPRS+SIM, DIGI-GPRS, DIGI-PSTN
App compatibility**	✓
Push notifications**	✓
Signalling protocols**	Contact ID IP, Contact ID, SIA IP, SIA3, Fast Format IP, Fast Format and SMS
Technical specification	
Power supply onboard	~15.0VDC
- Maximum rating	0.7A
Panel current consumption	222mA - 75mA
Battery capacity	2200mAh
Other details	
Operating temperature	-10°C to +40°C
Dimensions (W x H x D)	220 x 160 x 50mm
Weight	1025g inc. battery
Certifications	Security Grade 2 Environmental Class II

** App compatibility, push notifications and signalling protocol options are dependent on the communication module.



for more information

Enforcer



Two-way wireless kits

Easy ordering - everything you need in one pack; removing the need for individual product ordering to construct the equivalent system.



	Control Panel	Onboard WIFI	KX10DP-WE	MC1 MINI-WE	MC1/SHOCK-WE	DELTA/MOD-WE	KEYFOB-WE	LED RKP	ANDROID TABLET	App Compatible
ENF/KIT1-UK	Enforcer V11	WI-FI NOW ONBOARD	2	1	-	1	2	-	-	✓
ENF/KIT2-UK	Enforcer V11	WI-FI NOW ONBOARD	2	1	-	-	2	-	-	✓
ENF/KIT3-UK	Enforcer V11	WI-FI NOW ONBOARD	4	1	-	1	-	-	-	✓
ENF/KIT5-UK	Enforcer V11	WI-FI NOW ONBOARD	-	1	4	1	-	-	-	✓
ENF-TAB/KIT1-UK	Enforcer V11	WI-FI NOW ONBOARD	2	1	-	1	-	-	1	✓
ENF-TAB/KIT2-UK	Enforcer V11	WI-FI NOW ONBOARD	2	1	-	-	-	-	1	✓
ENF-RKP/KIT1-UK	Enforcer V11	WI-FI NOW ONBOARD	2	1	-	1	-	1	-	✓
ENF-RKP/KIT2-UK	Enforcer V11	WI-FI NOW ONBOARD	2	1	-	-	-	1	-	✓

Please note: Enforcer V11 control panels no longer come with a DIGI-WIFI in the modem slot. The WI-FI communicator is built onboard the main PCB. The AndroidTablet is compatible with Enforcer V11 software and hardware only.

COMING
SOON

Enforcer X 280



The next generation of security technology.

A whole new experience in commercial and large-residential security.

Enforcer X 280

Multi-path communications

Send all communications at the same time, without having to prioritise, with the Enforcer X 280's multi-path, multi-tasking communications channels.

Multiple ARCs

The Enforcer X 280 has 4 ARC destinations with up-to 3 paths for each ARC (cellular, Wi-Fi and LAN), allowing the control panel to talk to 4 separate ARCs or multiple accounts within the same ARC if required.

Hotspot mode

Hotspot mode can be used to program the panel if there's no internet available on-site. Working with a connected Wi-Fi communications modem, hotspot mode can be activated on the panel to broadcast its own Wi-Fi network and allow devices to connect to program the system through InSite Pro Local.

Simple Cloud

Cloud connection made simple. The Enforcer X 280 can be added to PyronixCloud by scanning the QR code found on the panel or by using the short code menu in the panel. With a working IP connection (Wi-Fi, LAN or cellular), the control panel will automatically connect to your PyronixCloud account.

App connectivity for control anywhere

Easy app connection. Just like the PyronixCloud, HomeControl2.0 can be connected by scanning the QR code found on the panel or by using the short code menu in the panel to view, arm and disarm areas. You can even access user functions like adding, changing and deleting user codes from the panel.

OTA updates

Futureproof installations with all-new Over-the-Air updates. You can now update the panel's firmware remotely, while the panel is installed in a customer's premises, through InSite ProCloud.

Updates will provide new panel features, taking approximately 15 minutes to download, unpack and install the new software. This all happens in a separate partition of the memory, protecting the current running software should a power cut or other unforeseen event interrupt the process.

99 areas, 4 levels

The Enforcer X 280 is our first control panel to use a new areas and levels feature. It offers 99 areas with 4 levels in each area, giving full flexibility for setting up the system.

System defaults on start-up

Choose your default start-up settings with the Enforcer X 280. When the system is first powered on, you can pick your system grading to configure the panel to your requirements.

New communication modules

The Enforcer X 280 has two newly designed, robust modules; a 4G/2G module and Wi-Fi module. The 4G/2G module will run 4G where possible, falling back to 2G when 4G signal strength is poor. The Wi-Fi module is 2.4GHz and offers all 13 channels of the 2.4GHz Wi-Fi range. The panel has LAN onboard for easy ethernet connection direct to a local router.

BUS Scan

Bus Scan is a brand new feature. Where RS485 Bus devices are traditionally programmed manually, Bus Scan automates the process on the Enforcer X 280. It will scan the RS485 bus and display any detected devices in groups on the panel's keypad. Save time on set up, especially on large systems, with the basic programming already done for you by Bus Scan.

Zone Scan

Zone Scan can detect wired inputs into the control panel and expanders with a simple scan. Once detected, it will setup basic programming for each; saving a lot of time and effort on manual input.

Auto Learn

Forget manually navigating the panel menu over and over again to add wireless devices. Auto Learn mode allows for automatic learning of any wireless device into wireless zone expanders with a simple click of the Auto Learn button on each device, enabling more efficient programming.

280 zones

Leave no space unprotected with 280 zones available on the Enforcer X 280, perfect for large residential and commercial properties.

Hybrid system

Connect the Enforcer two-way wireless range of devices to the Enforcer X 280 for full flexibility.

InSite Pro Local

InSite Pro Local is the new web browser interface we've built into our Enforcer X 280 control panel to help make installation and set-up a breeze. Configure panel settings quickly and easily on-site by directly connecting your device to the control panel or by using the Local Area Network.



InSite Pro Cloud

InSite ProCloud is our brand new platform hosted in the Cloud. It has all the legacy features of PyronixCloud, along with loads of new tools and improvements. It's the new platform for all of your cloud settings, including panel configuration and app user pages, which allows you to remotely program your panels, diagnose, and solve issues, without any need to upload settings offline and send back to the panel.



**COMING
SOON**

Enforcer X 280

Partcode	ENFX-280H/L
What's in the box	
Tamper protected housing	✓
PCB	✓
Power supply on board	✓
Keypad	x
Communications module	x
Key features	
Areas	99
Levels (areas x levels)	396 (99 x 4)
Maximum zones	280
- On board	8
Maximum ZEMs	30
Maximum programmable PGMs	459
- On board	8
Maximum PGM expanders	16
Arm/disarm methods	App InSite Pro Pin code Proximity tag Remote keyfob
User codes	500
- Guard/duress	20
System logs	5,000
User automation outputs	30
InSite Pro Local compatible	✓
InSite Pro Cloud compatible	✓
Wireless devices (requires wireless expander)	
Maximum zones	96
- Onboard	-
Maximum wireless expanders	3
Keyfobs	32
Arming stations	4
Sirens	2
Wired devices	
Maximum zones	280
- On board	8
Maximum programmable PGMs	459
- On board	8
Maximum keypads/readers	30
Communication	
Module compatibility	Wi-Fi 4G/2G
On board Ethernet	✓
HomeControl2.0 compatible	✓
Push notifications	✓
Signalling protocols*	Contact ID IP Contact ID SIA IP SIA3 Fast Format IP Fast Format
Technical specification	
Power supply on board	✓
- Quiescent output voltage	~15VDC
- Maximum rating	3.4A
Current consumption	130mA
Battery capacity	7-17Ah
AUX output voltage	~12VDC
Default zones resistors	2k2 tamper / 4k7 alarm
Other details	
Operating temperature	-10°C to +40°C
Dimensions (W x H x D)	305 x 390 x 100mm
Weight	11.5kg inc. battery (sold separately)
Warranty	2 years
Certifications	
Electrical conformity	UKCA CE
EN 50131	Security Grade 3
Environmental classification	II

*Signalling protocol options are dependent on the communication module installed

EURO and ENFORCER X

ENFORCER X
COMING
SOON

System architecture

The EURO and Enforcer X control panels are hybrid systems that can be expanded via the RS485 bus to add both wired or Enforcer two-way wireless peripherals to match any installation requirement.

— Wired

When utilising a fully wired system it delivers a user-friendly, robust and reliable solution, fully compliant to Grade 3.

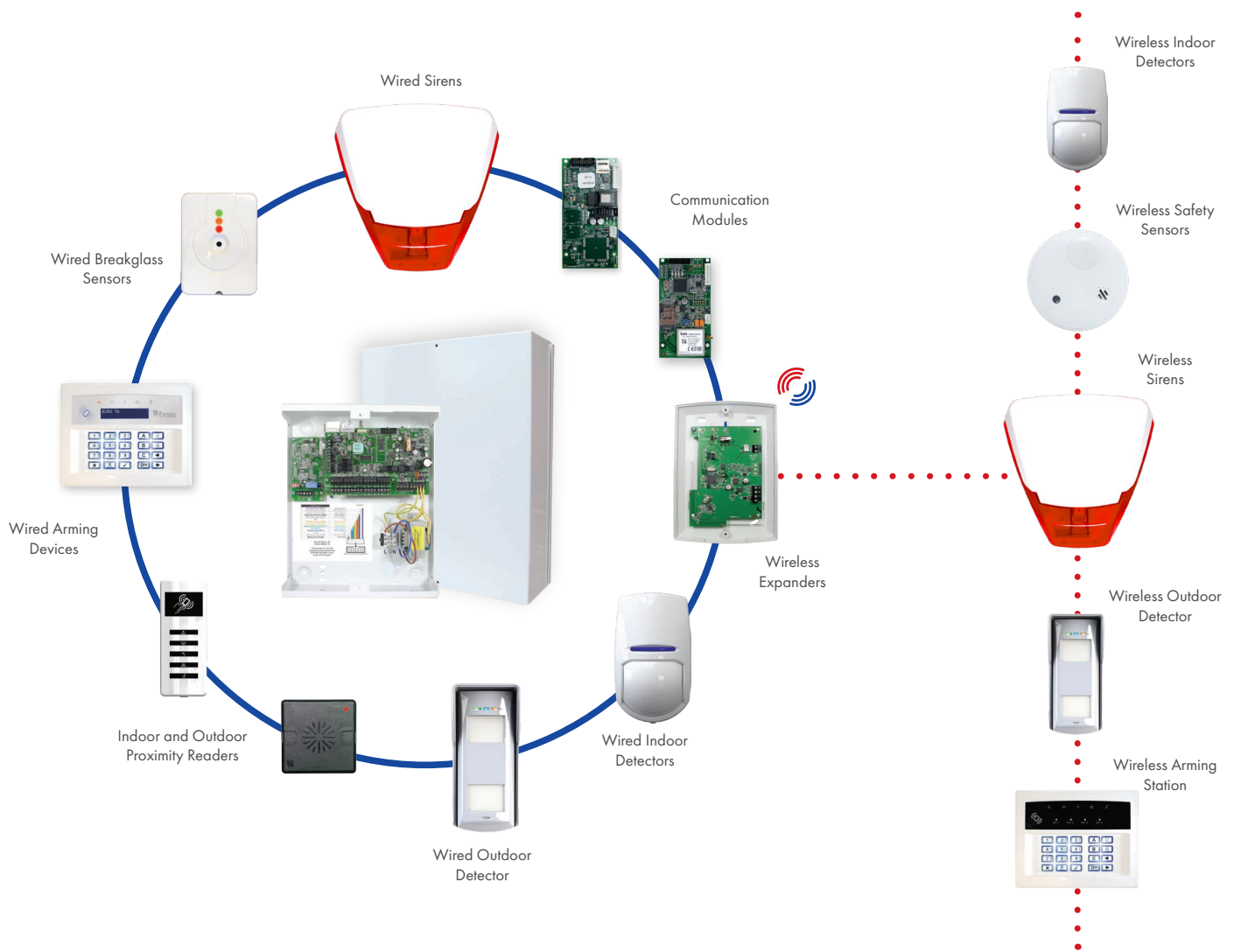

••••• Wireless

Where running cabling can be too invasive or impractical, award-winning Enforcer two-way wireless expansion provides you with quick-to-fit, effective solutions that maximise installation efficiency and are easy for your users to operate. This is ideal for listed buildings or retrofits.

EURO 46 V10

Future-proof the installation, fit one panel

It's time to streamline your security installations and maximise your opportunities. Wire in the panel and expand wirelessly with the EURO 46 V10; delivering everything from bells-only to app functionality.

Get to know one and master them all, with fully menu-driven programming

Easily navigate through the menus of the EURO 46 V10 with similar uniform menu-driven programming. Simple 'YES/NO' questions allow fast and efficient installing to save time and money.

Connect as required with the vast range of communication options

Whatever the communication need, the EURO 46 V10 gives you the option. Simply purchase the communicator you want and fit it into the panel.

No on-site IT configuration

The EURO 46 V10 is connected through a cloud server, so there is no need to set up static IP addresses or configure the network connection on site; instead you simply set up an account on PyronixCloud.com.

Completely secure control from anywhere in the world

Pyronix app and PyronixCloud communications are encrypted to the highest standard, so the user can securely arm and disarm the system, view status and receive push and voice push notifications from any event, from anywhere.

Save yourself time and money with Automatic Remote Maintenance

Using Pyronix InSite UDL software, the EURO 46 V10 can be remotely programmed and diagnosed. The software also enables one of the compulsory twice yearly system maintenance calls to be performed remotely.

Android and Apple compatible

HomeControl2.0 and ProControl+ are available in two versions: on Android™ from the Google Play Store and on iOS™ from the Apple App store.

Meet the required security standard with Grading options

The EURO 46 V10 can be either Grade 2 (EURO 46S V10) or 3 (EURO 46L V10) with full app capability, for the superior security any installation needs.

Recurring revenue and retention

Streams of recurring revenue can be established by offering PyronixCloud management services; managing this or passing access to users. This increases customer retention and makes the system more profitable.

Partcode	EURO46/S-UK	EURO46/L-UK
Specification features		
Onboard/maximum zones		8/76
Onboard/maximum outputs		5/85
Areas (independent or level)		6
Arm/disarm methods		App, pin, prox or keyfob
User codes		75
- Guard/duress		10
System logs		1250
Programmable automation types		30
Wireless devices (requires ZEM32-WE)		
Onboard/maximum zones		0/64
Keyfobs		32
Arming stations		4
Sirens		2
Onboard/maximum zones		
Onboard/maximum zones		10/46
Onboard/maximum outputs		6/85
Maximum keypads		6
Maximum readers		5
Communication		
Module compatibility	DIGI-WIFI/XA, DIGI-LAN, DIGI-GPRS+SIM, DIGI-GPRS, DIGI-PSTN	
App compatibility	✓	
Push notifications	✓	
Signalling protocols	Contact ID IP, Contact ID, SIA IP, SIA3, Fast Format IP, Fast Format and SMS	
Technical specification		
Power supply onboard	~21.0VAC	~21.0VAC
- Maximum rating	1.5A	2.0A
Panel current consumption	80mA	
Battery capacity	2-6Ah	7-17Ah
Other details		
Operating temperature	-10°C to +40°C	
Dimensions (W x H x D)	297 x 250 x 82mm	305 x 390 x 100mm
Weight	4.8kg inc. battery	11.5kg inc. battery
Certifications		
EN50131	Grade 2	Grade 3
Environmental class	II	II



for more information

Wired arming devices

Reliable, convenient, user-friendly arming and access control

From stylish keypads to resilient proximity readers, the versatile range of wired arming devices provides the ideal, easy-to-use system for any residential or commercial application.

	EUR-064	EURO LCDPZ/SCHROME	EURO-PROXI	EURO-PROXE
Specification features				
LCD keypad	✓	✓	x	x
Surface mounted	✓	✓	✓	✓
Flushmount back box available	x	✓	x	x
Interchangeable keypad casings	x	✓	x	x
Integrated proximity reader	✓	✓	✓	✓
Indoor-use proximity reader	✓	✓	✓	x
IP65 rated outdoor-use proximity reader	x	x	x	✓
Onboard zones	2	2	2	1
Onboard outputs	1	1	1	1
Access control	x	x	✓	✓
Power supply				
Power supply	12VDC (9-15 VDC)	12VDC (9-15VDC)	12VDC (9-15VDC)	12VDC (9-15VDC)
Current consumption	50mA	50mA	30mA	22mA
Zones	DEOL, 3EOL	DEOL, 3EOL	DEOL	DEOL
Output	100mA	100mA	150mA	150mA
Other details				
Operating temperature	-10°C to +40°C	-10°C to +40°C	-10°C to +40°C	-20°C to +60°C
Weight	258g	258g	130g	220g
Dimensions (W x H x D)	114 x 99 x 34mm	160 x 126 x 30mm	40 x 97 x 23mm	85 x 85 x 21mm
Certifications				
EN50131	Grade 3	Grade 3	Grade 3	Grade 3
Environmental class	II	II	II	IV

Wireless arming device



Easy-to-install, user-friendly and secure arming

Fast, convenient and easy-to-use control, the two-way wireless range of arming devices offer a non-invasive installation with an extensive transmission range, 128-bit encryption and more, for any Grade 2 system.

KEYFOB-WE

Multi-functional arming and disarming.



Specification features	
4 button with 8 button functions	✓
System status display	✓
Arm one or all areas per button	✓
Disarm one or all areas per button	✓
Hold-up function	✓
Activate output automation	✓
Lock and unlock buttons	✓
Electrical specifications	
Transmission frequency	868MHz, FM transceiver
Transmission method	128-bit encrypted radio protocol
3V Lithium battery included	BATT-KF1215 3V
Battery life - years (typical usage)	1
Weight & dimensions	
Weight	28g
Dimensions (W x H x D)	30 x 72 x 20mm
Certifications	
EN50131	Grade 2
Environmental class	II

LEDRKP/WHITE-WE

Convenient, wireless and easy to use.



Specification features	
ABS keypad with LED icon display	✓
Integrated proximity reader	✓
Entry and exit tones	✓
Backlit keys	✓
Dedicated keys for automation output control	4
3V / 5A Lithium battery included	BATT-ES1
Signal Strength Indicators (SSI)	✓
Certifications & warranty	
EN50131	Grade 2
Environmental class	II

for more information

Communication modules

	DIGI-LAN	DIGI-GPRS	DIGI-GPRS+SIM	DIGI-WIFI (ENFORCER)	DIGI-WIFI/XA (EURO 46)
					
Compatibility					
Smart device applications	✓	✓	✓	✓	✓
Enforcer V10	✓	✓	✓	✓	✗
Enforcer V11	✓	✓	✓	WIFI NOW ONBOARD	✗
EURO 46 V10	✓	✓	✓	✗	✓
EURO 280	✗	✗	✗	✗	✗
Specification features					
Formats	Contact ID IP, SIA 3 IP, supports uploading/downloading	Contact ID IP, SIA 3 IP, SMS, supports uploading/downloading	Contact ID IP, SIA 3 IP, SMS, supports uploading/downloading	Contact ID IP, SIA 3 IP, supports uploading/downloading	Contact ID IP, SIA 3 IP, supports uploading/downloading
Voltage	12VDC	12VDC	12VDC	12VDC	12VDC
Dimensions (W x H x D)	109 x 56 x 14mm	110 x 56 x 10mm	110 x 56 x 10mm	109 x 56 x 11mm	109 x 56 x 11mm
Roaming capabilities	✗	✓	✓	✗	✗
Certifications					
ATS	SP5	SP5	SP5	SP5	SP5
Environmental class	II	II	II	II	II

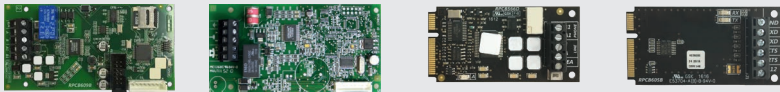
	DIGI-PSTN/VOICE*	DIGI-1200 (PSTN)*	FPPSTN-MODEM	FPRS232-MODEM
				
Compatibility				
Smart device applications	✗	✗	✗	✗
Enforcer V10	✓	✓	✗	✗
Enforcer V11	✓	✓	✗	✗
EURO 46 V10	✓	✓	✗	✗
EURO 280	✗	✗	✓	✓
Specification features				
Formats	Contact ID, SIA3, Fast Format, supports uploading/downloading	Contact ID	Contact ID, SIA, supports uploading/downloading	Chiron, WebWayOne SIA, supports uploading/downloading
Voltage	12VDC	12VDC	12VDC	12VDC
Dimensions (W x H x D)	110 x 56 x 10mm	110 x 56 x 10mm	60 x 30 x 12mm	60 x 30 x 12mm
Roaming capabilities	✗	✗	✗	✗
Certifications				
ATS	SP2	SP2	SP2	-
Environmental class	II	II	II	II

*Not recommended for future installations.

The DigiAir communication module



Add ARC connectivity to our app-enabled systems

Using the DigiAir with the Pyronix range provides connectivity directly from control panels to the monitoring station; all signal paths are fully encrypted and utilise the CSL managed network and Gemini servers.

Available from your local ARC in GPRS, Wi-Fi and LAN versions.



V2 TEL Speech Dialler

Flexible, convenient and programmable

The V2 TEL Speech Dialler enables communication of alarm information directly to telephone devices via PSTN connection*. Compatible with any brand of control panel via hardwired connection, it provides speech messages and can also be used as a normal telephone if required.

*Please note: The Public Switched Telephone Network (PSTN) switch off is due to take place by 2025, beginning for some in 2021. We suggest proactively focusing on IP solutions, while ensuring multi-path and GPRS are utilised to maintain professional monitoring with the ARC where required.



Partcode	V2TEL
Specification features	
Onboard / maximum inputs	6
Onboard / maximum outputs	4
Voice messages	6
SMS messages	x
Telephone numbers	9
Duplex	Half
Integrated microphone and speaker	✓
Integrated keypad	✓
Remote control via a telephone	✓
Automatic phone number recognition (CLIP)	x
Can be used as a telephone	✓
Date and time stamp	x
Event log	30
Anti-jamming feature	x
Other details	
Operating temperature	-20°C to +40°C
Dimensions (W x H x D)	147 x 100 x 28mm
Power supply	10-14VDC
Current consumption	300mA Max (40mA at rest)



for more information

Expanders

Zone



	EURO-ZEM8	EURO-ZEM8/E+ P-BOX	EURO-ZEM8+	EURO-ZEM8+PSU	EURO-ZEM32-WE
					
Type of module					
Wired zone expander module	✓	✓	✓	✓	✗
Two-way wireless expander module	✗	✗	✗	✗	✓
Specification features					
Wired zones	8	8	8	8	✗
Two-way wireless zones	✗	✗	✗	✗	32
Two-way wireless keyfobs	✗	✗	✗	✗	32
Two-way wireless sirens	✗	✗	✗	✗	2
Output support	✗	✗	4 open collector	4 open collector	✗
Housing with tamper protection	Plastic	Bought separately	Plastic	Metal	Plastic
Integrated power supply	✗	✗	✗	2.5A	✗
Power supply	9-15VDC	9-16VDC	9-15VDC	220-240VAC	9-15VDC
Other details					
Operating temperature	-10°C to +40°C	-10°C to +40°C	-10°C to +40°C	-10°C to +40°C	-10°C to +40°C
Weight	260g	33.5g	260g	4.8kg (including battery)	240g
Dimensions (W x H x D)	173 x 125 x 32mm	100 x 40 x 14mm	173 x 125 x 32mm	305 x 390 x 100mm	173 x 125 x 32mm
Certifications					
EN50131	Grade 3	Grade 3	Grade 3	Grade 3	Grade 2
Environmental class	II	II	II	II	II

Output

	EURO-OEM8R8T	EURO-OEM16R-PSU
		
Type of module		
Output expander module	✓	✓
Specification features		
Output support	8 open collector/8 relays	16 relays
Two-way wireless zones	✗	✗
Two-way wireless keyfobs	✗	✗
Two-way wireless sirens	✗	✗
Housing with tamper protection	Plastic	Metal
Integrated power supply	✗	2.5A
Power input	9-15VDC	220-240AC
Other details		
Operating temperature	-10°C to +40°C	-10°C to +40°C
Weight	240g	4.8kg (including battery)
Dimensions (W x H x D)	173 x 125 x 32mm	305 x 390 x 100mm
Certifications		
EN50131	Grade 3	Grade 3
Environmental class	II	II



UR2-WE

Compatible with any brand of alarm control panel with arm and disarm outputs.

The UR2-WE provides you with the ultimate installation flexibility, by delivering the capability to use the entire Enforcer two-way wireless range of peripherals on any brand of wired alarm control panel with an arm and disarm output.

So, whether installing new or upgrading existing systems, the UR2-WE enables the addition of up to 10 wireless sensors or 6 wireless keyfobs per channel*; giving the installation the flexibility it requires, with all the great benefits of multi-award-winning Enforcer two-way wireless technology.

*Please note: Each wireless channel can either support sensors or keyfobs, but not a combination of the two. Therefore, you can add up to 20 sensors or 12 keyfobs to the installation.

Partcode	UR2-WE
----------	--------

Specification features

Alarm relay outputs	2
Wireless frequencies	2**
Two-way wireless peripherals	10 per channel
Two-way wireless keyfobs	6 per channel
Wireless peripherals dedicated fault relay	1
System arm / disarm input	1
Alarm indication (7 segment display)	1

Electrical specifications

Power supply	9-15VDC
Current consumption min / max	80mA/400mA
Relay x 3	3A @ 30VDC

Other details

Operating temperature	-10°C to +50°C
Dimensions (W x H x D)	173 x 125 x 32mm

*Please note: The HUD/MED-WE is only compatible with UR2-WE software versions V4.03 and above.

** Please note: All peripherals must be dual frequency in order for the UR2-WE to switch frequency in the event of jamming.



for more information

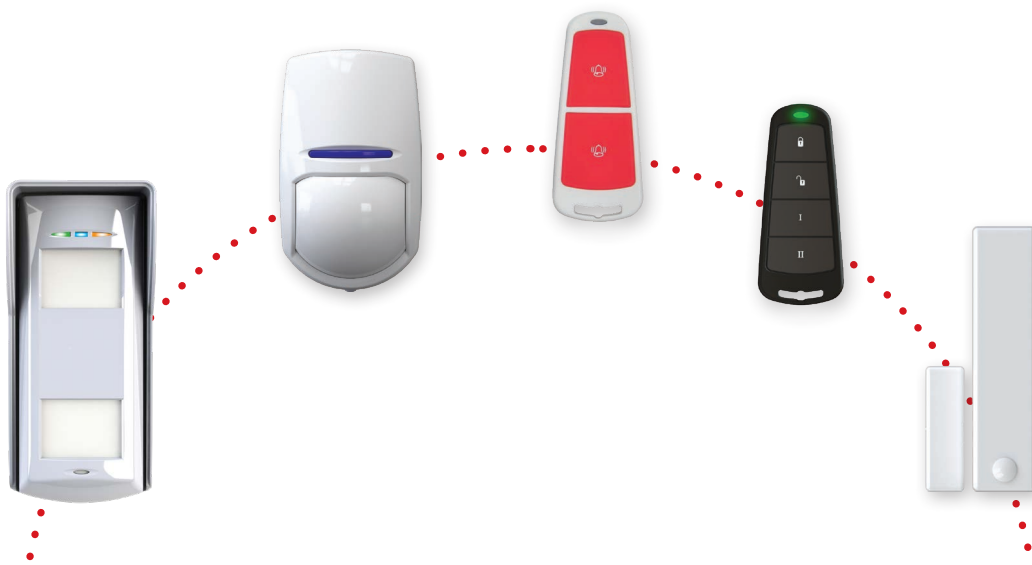



KX Detectors

Enforcer Two-way Wireless PIR Detectors

The ideal detection solution for areas where cabling would be unsuitable, the wireless KX range provides easy installation, adapts to its environment and offers pet immunity and coverage options.



Partcode	KX10DP-WE	KX12DQ-WE	KX15DC-WE	KX25LR-WE
Lens characteristics				
Volumetric lens 85° coverage, 7 planes, 60 zones	x	✓	x	x
Pet immune coverage, 6 planes, 56 zones	✓	x	x	x
Curtain lens, 20° coverage, 6 planes, 46 zones	x	x	✓	x
Long range lens, 20° coverage, 6 planes, 24 zones	x	x	x	✓
Maximum range	10m	12m	15m	25m
Optimum installation height	1.8-2.4m	1.8-2.4m	Max 4m	1.8-2.4m
Creep-zone protection	x	✓	✓	✓
Specification features				
Pet immune	<24kg	x	x	x
Blue Wave Technology (BWT)	✓	✓	✓	✓
Automatic sensitivity	✓	✓	✓	✓
Digital temperature compensation	✓	✓	✓	✓
Front and rear tamper protection included	✓	✓	✓	✓
Signal Strength Indicators (SSI)	✓	✓	✓	✓
Electrical specifications				
Transmission frequency	868MHz, FM transceiver			
Transmission method	128-bit encrypted radio protocol			
3V Lithium battery included	1 x CR123A	1 x CR123A	1 x CR123A	1 x CR123A
Battery life - years (typical usage)	2	2	2	2
Other details				
Operating temperature	-10°C to +40°C			
Weight	125g			
Dimensions (W x H x D)	69 x 117 x 50mm			
Certifications				
EN50131	Grade 2	Grade 2	Grade 2	Grade 2
Environmental class	II	II	II	II

For more accessories, please see page 61

Lens Diagrams

KX10DP-WE - volumetric lens

Vertical coverage

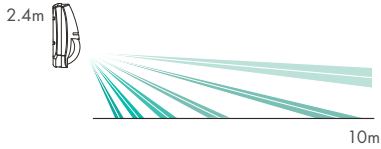

Horizontal coverage

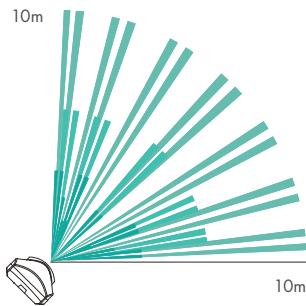

KX12DQ-WE - volumetric lens

Vertical coverage

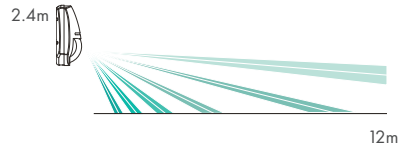

Horizontal coverage

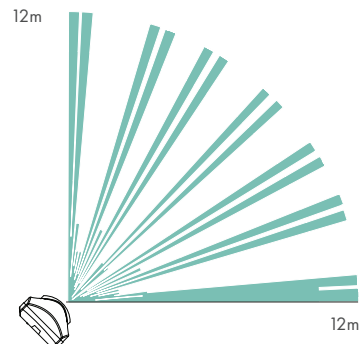

KX15DC-WE - curtain lens

Vertical coverage



Horizontal coverage



KX25LR-WE - long range lens

Vertical coverage

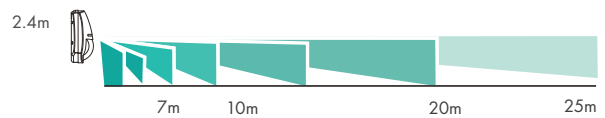

Horizontal coverage

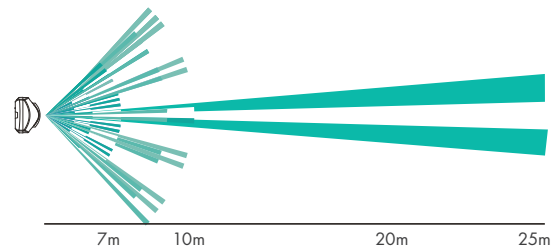

KX Detectors

Wired Indoor PIR Detectors

For any indoor installation where cabling isn't an issue, the wired KX range adapts to its environment, offers different coverage patterns, pet immunity options and onboard EOL resistors, to deliver the ideal solution.



Partcode	KX10DP	KX15ED	KX15DQ	KX18DC
Specification features				
Volumetric coverage: 85°, 7 planes, 60 zones	x	✓	✓	x
Pet detection: 85°, 6 planes, 56 zones	✓	x	x	x
Curtain coverage: 20°, 6 planes, 46 zones	x	x	x	✓
Long range coverage: 20°, 6 planes, 24 zones	x	x	x	✓
Maximum range	10m	15m	15m	18m/30m LR
Optimal installation height	1.8-2.4m	1.8-2.4m	1.8-2.4m	Max 4m/1.8-2.4m
Creep-zone protection	x	✓	✓	✓
Specification features				
Pet immune	<24kg	x	x	x
Blue Wave Technology (BWT)	✓	✓	✓	✓
Automatic sensitivity	✓	✓	✓	✓
Digital temperature compensation	✓	✓	✓	✓
Optical quad	x	x	✓	x
EOL resistors onboard	✓	✓	✓	✓
Tamper protection included	✓	✓	✓	✓
Electrical specifications				
Power supply	9-16VDC (12VDC nominal)			
Current consumption at rest and in alarm	11mA, 13mA			
Output relay	Solid state, 60VDC, 50mA protection			
Tamper terminal	12VDC max, 50mA max			
RFI immunity from continuous wave (CW), modulated wave (AM) and pulse (PM) 80-2700MHz	10 V/m			
Alarm relay open time	2.5 seconds			
Detection speed	0.3-3m/s			
Direct light filter	6500 Lux			
Optics	Sealed optics			
Geometric lens configuration	3D			
Other details				
Operating temperature	-10°C to +40°C			
Weight	125g			
Dimensions (W x H x D)	69 x 117 x 55 mm			
Certification				
EN50131	Grade 2	Grade 2	Grade 2	Grade 2
Environmental class	II	II	II	II

Lens Diagrams

KX10DP - volumetric lens
Vertical coverage

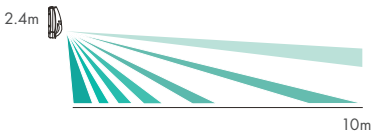

Horizontal coverage

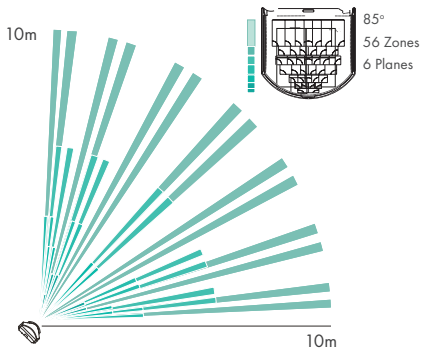

Lens: KX15VL

KX15DQ - volumetric lens
Vertical coverage

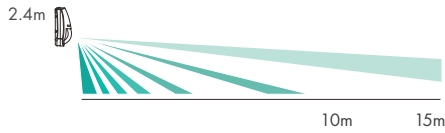

Horizontal coverage

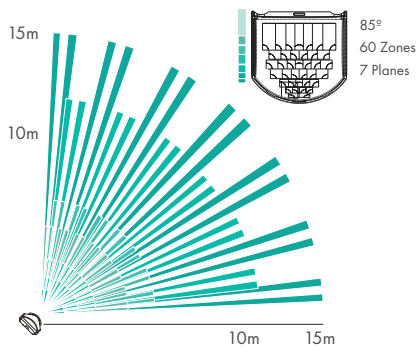

Lens: KX15VL

KX18DC - long range lens
Vertical coverage

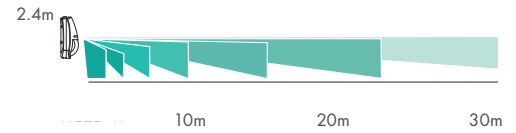

Horizontal coverage

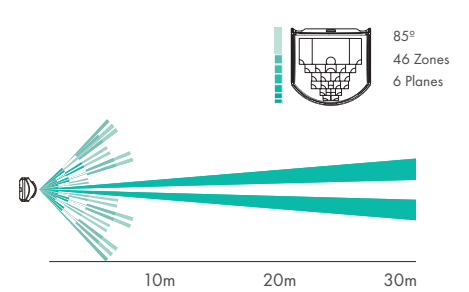

Lens: KX30LR

KX18DC - curtain lens
Vertical coverage

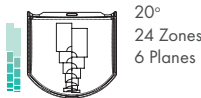
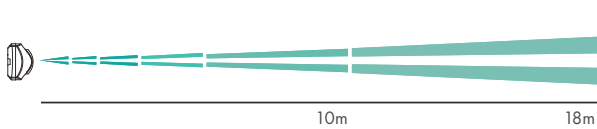

Horizontal coverage

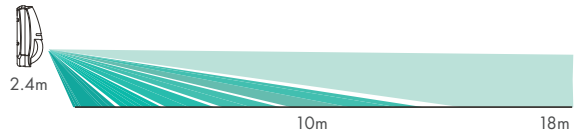
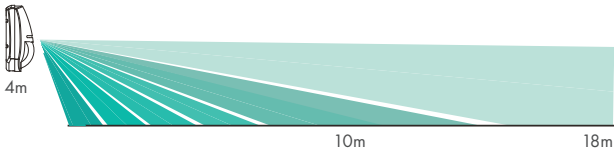

MEQ Blue

Compact Wired PIR Detector

A small and stylish passive infrared (PIR) detector, which provides excellent reliability and false alarm immunity.

Sealed optics

Protects from possible infestation from insects, shields air movement in front of the pyroelectric sensor and protects against adverse reflections from inside the detector housing.

ABS plastics

3mm polished finish, reduces electrostatic interference on the PIR sensor.

Automatic temperature compensation

When the product is used in a hot environment this technology automatically adjusts the detector's sensitivity allowing it to maintain its range even when the background room temperature is almost equal to the external body temperature of 32°C.



Partcode	MEQ BLUE
Optical and range features	
Coverage	Volumetric coverage: 90°, 108 zone and 3 planes
Maximum range	12m
Optimal installation height	1.8-2.4m
Specification features	
Dual element pyroelectric sensor	✓
Adjustable sensitivity	✓
Tamper protection	✓
Electrical specifications	
Operating voltage	9-16VDC
Quiescent current consumption	15mA @ 12VDC
Output relay	SELV limits, 60VDC, 50mA (42.4VAC peak)
Tamper switch	12VDC 50mA
Other details	
Operating temperature	-10°C to +40°C
Weight	80g
Dimensions (W x H x D)	88 x 60 x 42mm
Certifications	
EN50131	Grade 2



for more information

MEQ Blue
Horizontal coverage

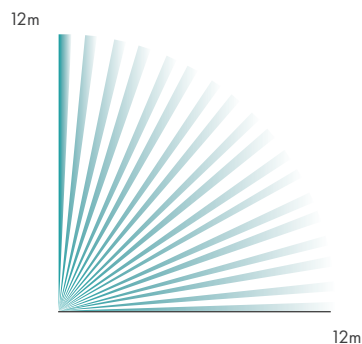

MEQ Blue
Vertical coverage



OCTOPUS DQ

Wired Ceiling Mount PIR

The Octopus DQ ceiling mount quad element passive infrared (PIR) detector offers an alternative solution. With 360° coverage, superior plastics and optimised installation, it can be fitted to cover aisles in shops, office spaces, storage rooms and more.

Quad Zone PIR

The Octopus DQ's Passive Infrared (PIR) sensor increases the detection capabilities when ceiling mounted, due to the crossing of opposing detection zones that are required to generate an alarm condition.

Pulse count (1, 2 & 3)

This is an adjustable feature to determine the number of pulses that are required to be triggered before an alarm activation occurs.

Walk test LED

Allows the installer to perform an easy and quick walk-test during the installation process, with the LED indicating the presence of an intruder.



Partcode	OCTOPUSDQ
Optical and range features	
Coverage	Volumetric coverage: 360°, 156 zone, 3 planes
Maximum range	12m
Optimal installation height	2.4-4m
Ceiling mount PIR	✓
Specification features	
Quad-interlocking element pyroelectric sensor	✓
Independent Floating Threshold (IFT) technology	✓
Adjustable sensitivity	✓
Automatic temperature compensation	✓
Power supply	9-16VDC (12VDC nominal)
Output relay	Solid state, 60VDC, 50mA protection
Tamper terminal	12VDC max, 50mA max
Selectable EOL resistors	✓
RFI immunity from continuous wave (CW), modulated wave (AM) and pulse (PM) 80-700MHz	10V/m
Alarm response	2.5 seconds
Detection speed	0.3-3m/s
Geometric lens configuration	3D
Certification	
EN50131	Grade 2
Environmental class	II



for more information

OCTOPUS DQ
Horizontal coverage

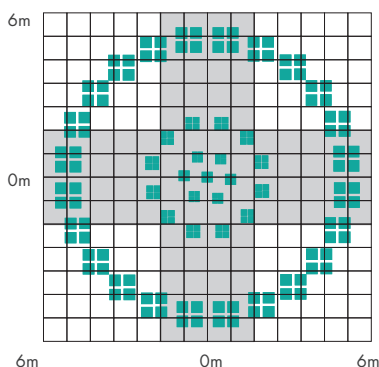

OCTOPUS DQ
Vertical coverage

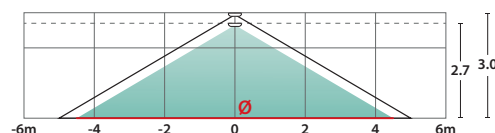



KX Detectors

Enforcer Wireless Indoor Dual Technology Detectors

The ideal detection solution for any hostile environments where cabling would be unsuitable; providing stable and reliable performance, with fast and efficient installation.



Partcode	KX10DTP-WE	KX12DT-WE
Optical and range features		
Maximum range	10m	12m
Optimal installation height	1.8-2.4m	1.8-2.4m
Creep-zone protection	x	✓
Specification features		
Pet immune	<24kg	x
Blue Wave Technology (BWT)	✓	✓
Automatic sensitivity	✓	✓
Digital temperature compensation	✓	✓
Anti-cloaking	x	x
Separate indication: microwave, PIR and alarm	✓	✓
3 microwave frequencies to avoid interference	✓	✓
Tamper protection included	✓	✓
Signal Strength Indicators (SSI)	✓	✓
Wireless electrical specifications		
Transmission frequency	868MHz, FM transceiver	
Transmission method	128-bit encrypted radio protocol	
3V Lithium battery included	2 x CR123A	
Battery life - years (typical usage)	2	
Electrical specifications		
RFI immunity from continuous wave (CW), modulated wave (AM) and pulse (PM) 80-2700MHz	10v/m	
Microwave frequency	9.9, 10.525, 10.587GHz	
Alarm response	-	
Detection speed	0.3-3m/s	
Direct light filter	>2500 Lux	
Optics	Sealed	
Geometric lens configuration	3D	
Other details		
Operating temperature	-10°C to +40°C	
Weight	135g	
Dimensions (W x H x D)	69 x 117 x 59mm	
Accessories		
Wall/ceiling brackets (KXBRACKET-C, KXBRACKET-W)	Sold separately	
Long range and curtain lenses (KX30-LR, KX18-LC)	Sold separately	
Bracket back tamper kit	Sold separately	
Certification		
EN50131	Grade 2	Grade 2
Environmental class	II	II

Lens Diagrams

Enforcer Wireless Indoor Dual Technology Detectors

KX10DTP-WE and KX10DTP - volumetric lens
Vertical coverage

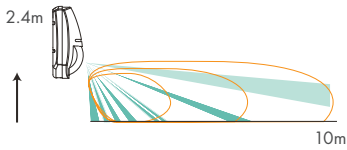

KX12DT-WE - volumetric lens
Vertical coverage

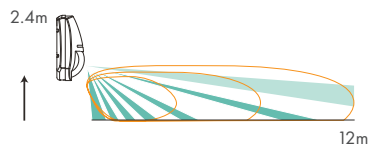

Horizontal coverage

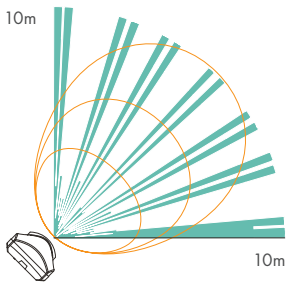

Horizontal coverage

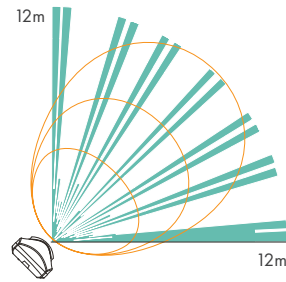

Lens Diagrams

KX15DT - KX15DTAM - volumetric lens
Vertical coverage

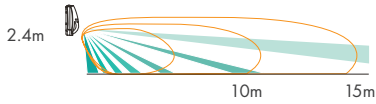

Horizontal coverage

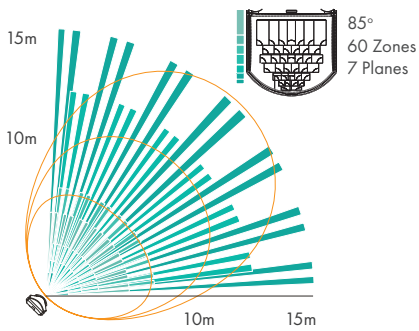

KX15DTAM - 30m long range lens
(30m long range PIR with anti-masking)
Vertical coverage



Horizontal coverage

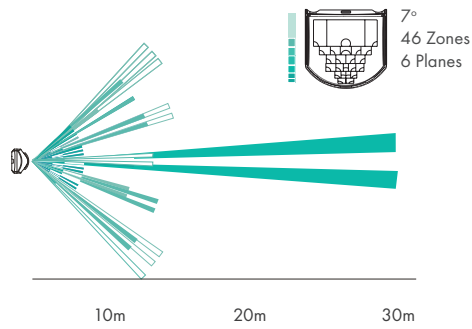

KX15DTAM - 18m long range lens
(18m long range PIR with anti-masking)
Vertical coverage

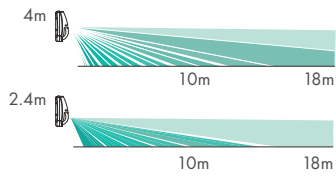

Anti-masking

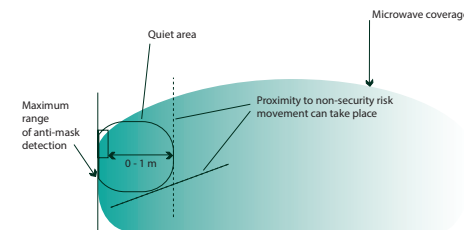

Horizontal coverage

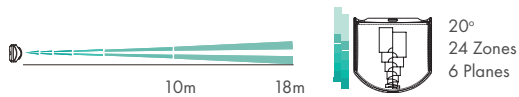

KX Detectors

Wired Indoor Dual Technology Detectors

For any wired installation requiring secure detection in hostile environments, the KX offers the ideal solution. Easy to install with onboard EOL resistors and adapting to its environment, the range even has a Grade 3 variant to suit any installation need.



Partcode	KX10DTP	KX15DT	KX15DTAM
Optical and range features			
Coverage	Volumetric	Volumetric	Volumetric, Curtain, Long range
Maximum range	10m	15m	15m/18m/30m
Optimal installation height	1.8-2.4m	1.8-2.4m	1.8-2.4m
Creep-zone protection	x	✓	✓
Specification features			
Adjustable anti-masking	x	x	✓
Anti-blocking	x	x	✓
Pet immune	<24kg	x	x
Blue Wave Technology (BWT)	✓	✓	✓
Automatic sensitivity	✓	✓	✓
Digital temperature compensation	✓	✓	✓
Anti-cloaking	AND/OR	AND/OR	AND/OR
Separate indication: microwave, PIR and alarm	✓	✓	✓
3 microwave frequencies to avoid interference	✓	✓	✓
EOL resistors onboard	✓	✓	✓
Tamper protection included	✓	✓	✓
Electrical specifications			
Power supply	9-16VDC (12VDC nominal)		
Current consumption at rest and in alarm	23mA, 30mA		
Output relay	Solid state , 60VDC, 50mA protection		
Tamper terminal	12VDC max, 50mA max		
RFI immune from continuous wave (CW), modulated wave (AM) and pulse (PM) 80-2700MHz	10v/m		
Microwave frequency	9.9, 10.525, 10.587GHz		
Alarm response	2.5 second		
Detection speed	0.3-3m/s		
Direct light filter	2500 Lux		
Optics	Sealed		
Geometric lens configuration	3D		
Other details			
Operating temperature	-10°C to +40°C		
Weight	125g		
Dimensions (W x H x D)	69 x 117 x 55mm		
Certification			
EN50131	Grade 2	Grade 2	Grade 3
Environmental class	II	II	II



TMD15

Tri-Anti-Masking Confirmation Detector

Featuring a non-overlapping PIR and a dual technology detector in one housing, the TMD15 delivers sequential confirmation, with outstanding detection performance and separate relay outputs.



for more information

Partcode	TMD15
Optical and range features	
Dual technology lens volumetric coverage: 90°, 30 zone and 3 planes	✓
PIR lens volumetric coverage: 69°, 24 zone and 3 planes	✓
Combined non-overlapping detector	✓
Maximum range	15m
Optimal installation height	1.8-2.4m
Specification features	
Dual element pyroelectric sensor	✓
Digital temperature compensation	✓
Microwave frequencies to avoid cross-talk	✓
Adjustable sensitivity	✓
Adjustable anti-masking	✓
Tamper protection	✓
Separate LED indication	✓
Electrical features	
Operating voltage	9-16VDC
Quiescent current consumption	15mA @ 12VDC
Output relay	3x SELV limits, 60VDC, 50mA (42.4VAC peak)
Tamper switch	12VDC, 50mA
Frequency range	10.579GHz, 10.587GHz, 10.595GHz
Other details	
Operating temperature	-10°C to +40°C
Weight	206g
Dimensions (W x H x D)	70 x 175 x 40mm
Certifications	
EN50131	Grade 3
Environmental class	II

TMD15 Lens Diagrams

TMD15 Horizontal coverage

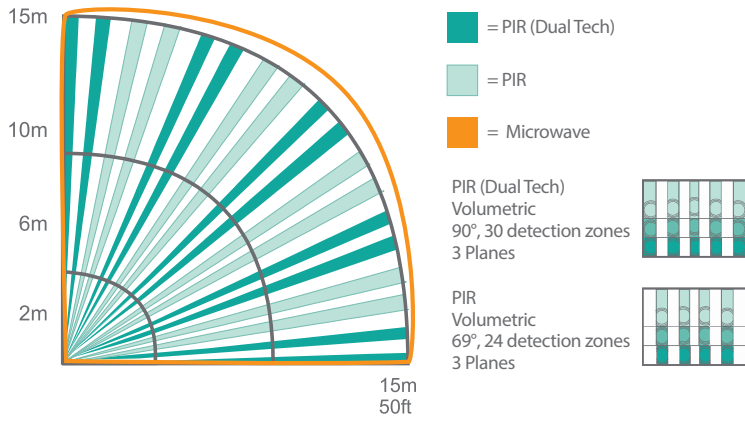

TMD15 Vertical coverage

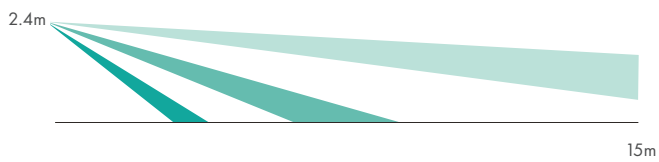

Minimum range setting



CarDefender



Selectable Detection Modes

Once the device has been professionally installed on the system, users have the option to configure shock, tilt or either shock/tilt to their preference by pressing and holding the button on the front.

• Tilt only

Tilt mode has one setting, on or off. The device requires a tilt angle of 4° to trigger the detector.

• Shock only

Shock mode has three sensitivity settings; low, medium and high. At the highest setting, the detector will trigger with less force. The lowest setting requires more force to trigger.

• Tilt or Shock

This mode will activate on either shock or tilt detection - an intruder hitting the vehicle or tilting the steering wheel will activate the alarm.

Universal Mounting

The device comes with a specially designed, brightly-coloured silicone rubber mount, allowing users to strap it to a vehicle's steering wheel for reliability and visual deterrence. Alternatively, the device can be secured with the included 3M tape for a wide variety of use cases.

Back to Home (B2H)

The CarDefender secures vehicles within home range of the control panel*. Where the vehicle has left the home range and later returned, the device's supervision will reset after 5 minutes or the user can reset it manually by pressing the B2H button on the device, which is the recommended method. The device will indicate signal strength with a flashing LED; green indicates good signal strength and red suggests poor.

*Obstructions may interrupt signal strength if the vehicle is parked on a public road or street outside the property.

The 10 Minute Safety Feature

Once users have selected their chosen settings, these are locked-in after a period of 10 minutes. This feature stops users accidentally changing the settings and potentially invalidating the device. Once locked, the settings can only be changed by opening and closing the device to enable another window for set up.

Conformally Coated PCB

The CarDefender's PCB is conformally coated, so it can be used in changeable environments*, making it ideal for bikes, vans or trailers too.

*As the device is not IP rated, it is not recommended for harsh, wet conditions or environments where it is exposed to the elements.

Partcode	CARDEFENDER-WE
Specifications	
Dimensions and weight (W x H x D)	Device - 30 x 95 x 10mm, 30g Holder - 122 x 163 x 12mm, 35g
Casing / Colour	Device - 2mm polycarbonate-ABS, anthracite Holder - Silicone strap, yellow UV Additive RIASORB UV-329 holder, black
LED colours	Red, blue and green
Transmission frequency	868MHz FM transceiver narrow band
Transmission method	Fully encrypted rolling code
Detection methods	Shock Tilt Shock
Tilt alarm threshold	~4°
Shock sensitivity	Low, medium and high
Battery	2 x lithium CR2450R, 3V, 500mAh with a 50mA pulse
Low battery threshold	2.2V +/-5% @ 25°C
Temperature	Storage: -20°C to 50°C Operating: -10°C to 40°C
Standards	EN50131-2-6-2008 EN50131-2-8-2016
RoHS Directive	EU 2015/853 UK RoHS regulation 2012
RE Directive	2014/53/EU Radio Equipment Regulations 2017 (RED)
Emissions	EN 55032:2015+A11:2020 Class B
Immunity compliance	EN 50130-4:2011+A1:2014
Environmental class	II

Vehicle Protection

The CarDefender has been developed to combat vehicle theft, (particularly keyless) offering a new line of defence to deter intruders by raising the house alarm in the event of an attempted theft. Users are given early warning, allowing them to take action as soon as possible, where previously, the theft may have gone unnoticed for some time.





Shock Sensor

Wired Shock Sensor

The wired shock sensor delivers reliable security detection, without needing movement. Providing users the freedom to move around while the system remains secured.

Piezoelectric sensor detection

The detector does not contain any moving parts and is therefore non-gravity dependent - the SHOCK/W can be installed in any plane or orientation.

Adjustable sensitivity

The pulse count is selectable and can be set to 1, 2, 4 or 6.

Gross attack detection

A vibration higher than the calibrated sensitivity will override the pulse count feature and directly activate the alarm output.

24 hour protection

The alarm system can be left permanently armed, as the wired shock sensor offers secure perimeter detection with the freedom to move around.



Partcode	SHOCK/W
Specification features	
Detection method	Piezoelectric sensor
Range	2.5m radius (nominal)* Sensitivity adjustable
Digital Signal Processing	✓
Sensitivity settings	High/low range
Potentiometer fine tuning	✓
Pulse count	1, 2, 4 or 6
LED enable	By jumper
Latching feature	By jumper
Front and rear tamper protection	✓
Removable electronics	✓
Gross attack activation	✓
Electrical specifications	
Power supply	~9-16VDC (12VDC nominal)
Quiescent current consumption	~16mA @ 12VDC
Maximum current consumption	~30mA @ 12VDC
Output relay	Solid state, 12VDC, 50mA protection
Tamper terminal	12VDC max, 50mA max
Other details	
Casing	ABS plastics (White)
Operating temperature	-10°C to +40°C
Weight	38.8g
Dimensions (W x H x D)	29 x 107 x 21.5mm
Certifications	
EN50131	Grade 2
Environmental class	II

* 2.5m radius value stated is typical. In some environments, this value may differ.



for more information



XD Detectors

Two-way Wireless Outdoor Detector

With perimeter protection and video verification in mind, the XDL12TT-WE is the ideal wireless outdoor detection solution; delivering reliable performance in fluctuating weather conditions, with flexible and simple installation.

Flexible installation

A range of mounting options are available to deliver the perfect angle and coverage pattern. The XDL12TT-WE can also be purchased in three different frequency bands to avoid any cross-talk; optimising the XD's stability and allowing it to be fitted with a fixed bracket to enable two XDL12TT-WE's to be fitted back to back to provide 24m range with 180° volumetric coverage.

Adaptable coverage

The XDL12TT-WE can provide either volumetric or curtain coverage. Each lens can also be restricted to avoid busy roads or paths, which could otherwise cause false alarms.

Easy setup

The XDL12TT-WE can be fitted with maximum installation ease and convenience:

- Walk test buzzer
- Status LED indication
- Adjustable MW range
- Adjustable PIR coverage angle
- DIP switches
- One-push-to-learn
- Signal Strength Indicators (SSI)

Video verification via ProControl+

The XDL12TT-WE can be linked to the LightCamera or any Hikvision video device to provide early warning alerts and video to any potential intrusion via ProControl+, should the XD be triggered.



Partcode	XDL12TT-WE
Optical and range features	
Coverage	85° volumetric lens
Maximum range	12m
Pet immune	Up to 24kg
Installation type	XD low mount
Optimal installation height	1.2m
Specification features	
Two-way wireless	✓
Tri-signal detection logic	2 x infrared + 1 x microwave
Automatic sensitivity	✓
Digital IFT technology	✓
Digital temperature compensation	✓
3 LED indication for microwave, infrared and alarm	✓
Integrated walk test buzzer	✓
Tamper	✓
Electrical specifications	
Transmission frequency	868MHz, FM transceiver
Transmission method	128-bit encrypted radio protocol
3V Lithium battery included	2x 3V 5Ah (BATT-ES1)
Battery life - years (typical usage)	3
Plastic housing material	Polycarbonate
PCB	Anti-humidity
Optics	Sealed
Lens UV protection	UV Filter
Environmental protection grade	IP55
Other details	
Operating temperature	-40°C to +80°C
Weight	300g
Dimensions (W x H x D)	77 x 189 x 84mm
Accessories	
2 flexible masking grids	✓
2 fixed masking grids to create curtain protection	✓
Certifications	
EN50131	Grade 2
Environmental class	IV



for more information

XD Coverage

Coverage pattern and features

The XDL12TT-WE has been developed with maximum performance, ease of installation and reliability in mind.

XDL Detector - Low mount installation 1.2m

The optics of the XDL12TT-WE are designed to be installed at a low mounting height of 1.2m, which gives a larger immunity to animals.

XDL12TT-WE lens diagrams

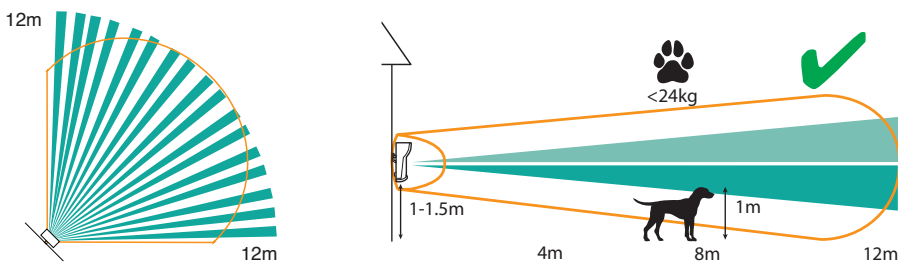

XD Detectors

Wired Outdoor Detector

The wired XD variants feature Anti-Interference Technology to prevent intruders from bypassing detection. This consists of anti-masking; protecting against attempts to mask any of the three sensors, alongside anti-blocking; preventing any arming of the system if something is blocking the vision of any of the sensors.



Partcode	XDH10TT-AM	XDL12TT-AM
Optical and range features		
Coverage	90°C volumetric lens	85°C volumetric lens
Maximum range	10m	12m
Installation type	XD high mount	XD low mount
Optimal installation height	2.4m	1.2m
Adjustable anti-masking (anti-spray) technology	✓	✓
Specification features		
Anti-masking (anti-spray)	✓	✓
Anti-blocking technology	✓	✓
Pet immune	Up to 10kg	Up to 24kg
Triple detection logic: 2 x infrared + 1 x microwave	✓	✓
Automatic sensitivity	✓	✓
Independent Floating Threshold (IFT) technology	✓	✓
Digital temperature compensation	✓	✓
Separate indication: microwave, infrared, alarm	✓	✓
3 microwave frequencies to avoid interference	✓	✓
Integrated walk test buzzer	✓	✓
DEOL resistors onboard	✓	✓
Tamper protection included	✓	✓
Electrical specifications		
Tamper protection	Front and rear	
Current consumption	23mA at rest/ 30mA in alarm	
Relay	Alarm NC, Tamper, Mask/Fault, Alarm NO	
Power	9-16VDC, 13.8VDC-13.8VDC nominal	
Microwave frequency	9.9, 10.525, 10.587GHz	
Direct light filter	>2500 Lux	
Optics	Sealed optics	
Protection	IP55	
Other details		
Operating temperature	-30°C to +50°C	
Weight	300g	
Dimensions (W x H x D)	77 x 118 x 84mm	
Certifications		
EN50131	Grade 2	Grade 2
Environmental class	IV	IV

XD Coverage

Coverage pattern and features

XDH Detectors - High mount installation 2.4m

The optics of the XDH10TT-AM detector are specifically designed for maximum protection at an installation height of 2.4m: 78 zones, 5 planes, and the 90° coverage provide complete volumetric coverage of the protected area.

XDL Detectors - Low mount installation 1.2m

The optics of the XDL12TT-AM are designed to be installed at a low mounting height of 1.2m, while the Dual-Vision Pet Immune setup of non-overlapping PIRs alongside Tri-signal Detection Logic delivers highly secure sequential detection and increases its tolerance to pet immunity.

XDH10TT-AM lens diagrams with the XD-Lens5

Horizontal coverage

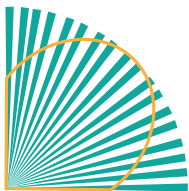

Vertical coverage

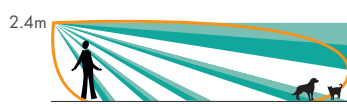

XDL12TT-AM

Horizontal coverage

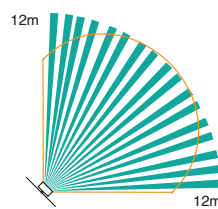

Vertical coverage

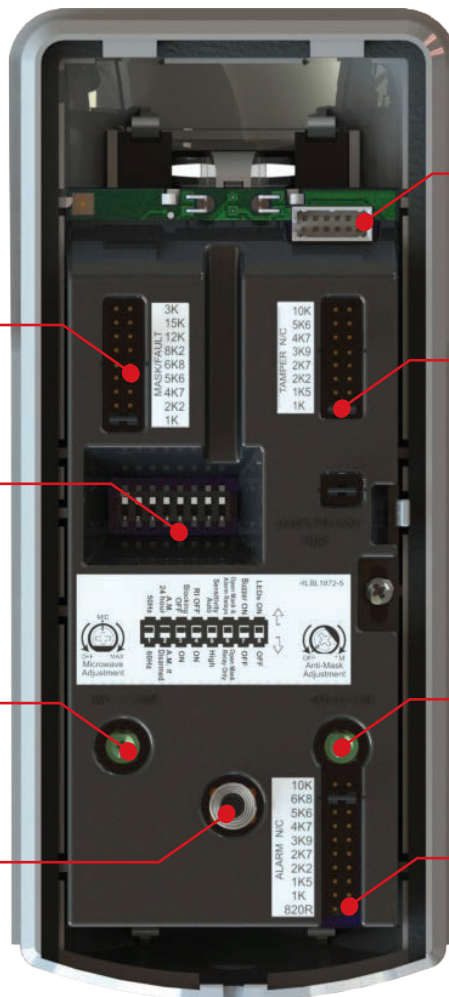
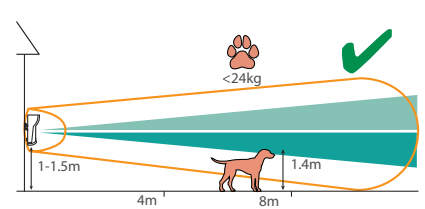

Connector to the terminal block module

EOL resistors for the tamper relay

Anti-mask range adjustment

EOL resistors for the alarm relay

EOL resistors for the mask/fault relay

DIP switches for programming

Microwave range adjustment





Front and back tamper







Contacts/Sensors

Enforcer Two-way Wireless Magnetic Contacts and Shock Sensors

Deliver the ideal perimeter protection that also gives the user the freedom to move around, without triggering an alarm when the system is armed. The range even includes the MCNANO-WE which can be fitted within a uPVC door frame and offer functions for various use cases.

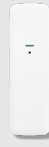
Partcode	MCNANO-WE	MC1MINI-WE	MC2-WE	MCEXTERNAL-WE
				
Characteristics				
Device dimensions (W x H x D)	29 x 69 x 10mm	27 x 104 x 25mm	36 x 115 x 30mm	40 x 146 x 40mm
Magnet dimensions (W x H x D)	14 x 69 x 10mm	14 x 49 x 16mm	13 x 56 x 17mm	30 x 146 x 40mm
Overall weight	40g	70g	70g	250g
Casing colours available	White, brown, anthracite	White, brown, anthracite	White, brown	Anthracite
Casing material	2mm polycarbonate-ABS	2mm polycarbonate-ABS	2mm polycarbonate-ABS	(2mm / 2.5 to 4mm) polycarbonate
Wireless	✓	✓	✓	✓
Wired	x	x	x	x
Tamper protection	Front and rear	Front and rear	Front and rear	Front and rear
Visual indications	Red, blue and green LEDs	Red, blue and green LEDs	Red, blue and green LEDs	Red, blue and green LEDs
Performance				
Magnetic contact detection	✓	✓	✓	✓
Vibration detection	x	x	x	x
External input option	x	x	✓	✓
Signal strength indicators (SSI)	✓	✓	✓	✓
Instant two way device control (ITDC)	✓	✓	✓	✓
Pyronix intelligent jamming detection	✓	✓	✓	✓
One push to learn	✓	✓	✓	✓
Transmission frequency	868MHz FM transceiver narrow band	868MHz FM transceiver narrow band	868MHz FM transceiver narrow band	868MHz FM transceiver narrow band
Transmission method and range	Fully encrypted rolling code, 300m	Fully encrypted rolling code, 300m	Fully encrypted rolling code, 300m	Fully encrypted rolling code, 300m
Nominal temperature	-10°C to 50°C	-10°C to 50°C	-10°C to 50°C	-25°C to 60°C
Batteries				
Type	1 x CR2450R, 3V	1 x CR123A, 3V	1 x CR2, 3V	1 x CR123A, 3V
Low voltage alert	2.2V +/- 5% @ 25°C	2.5V +/- 5% @ 25°C	2.5V +/- 5% @ 25°C	2.2V +/- 5% @ 25°C
Life expectancy	2 years	2 years	2 years	2 years
Standards				
Security grade	2	2	2	2
Environmental class	II	II	II	II
IP rating	-	-	-	65
EN certifications	EN50131-2-6:2008 EN50131-5-3:2017 PD6662:2017	EN50131-2-6:2008 EN50131-5-3:2017 PD6662:2017	EN50131-2-6:2008 EN50131-5-3:2017 PD6662:2017	EN 50131-2-2:2017 EN50131-1-1:2006+A3:2020 PD 6662:2017
Electrical conformity	CE, UKCA	CE, UKCA	CE, UKCA	CE, UKCA
Warranty	2 years	2 years	2 years	2 years





Partcode	MC1Z1-WE	MC1Z2/SHOCK-WE	ASSET-WE	NANO/SHOCK-WE
				
Characteristics				
Device dimensions (W x H x D)	125 x 25.5 x 28mm		30 x 95 x 10mm	30 x 95 x 10mm
Magnet dimensions (W x H x D)	125 x 15 x 16mm		-	-
Overall weight	95g		30g	30g
Casing colours available	White, brown, anthracite		White	White, brown, anthracite, black
Casing material	2.5mm ABS		2mm polycarbonate-ABS	2mm polycarbonate-ABS
Wireless	✓		✓	✓
Wired	x		x	x
Tamper protection	Passive, Closed Contact		Front and rear	Front and rear
Visual indications	-		Red, blue and green LEDs	Red, blue and green LEDs
Performance				
Magnetic contact detection	✓	✓	x	x
Vibration detection	-	✓	x	✓
External input option	1	2	✓	x
Signal strength indicators (SSI)	✓	✓	x	✓
Instant two way device control (ITDC)	✓	✓	✓	✓
Pyronix intelligent jamming detection	✓	✓	✓	✓
One push to learn	✓	✓	✓	✓
Transmission frequency	868MHz FM transceiver narrow band		868MHz FM transceiver narrow band	868MHz FM transceiver narrow band
Transmission method and range	Fully encrypted rolling code		Fully encrypted rolling code, 300m	Fully encrypted rolling code, 300m
Nominal temperature	-10°C to 50°C		-10°C to 40°C	-10°C to 40°C
Batteries				
Type	3.0V CR123A Lithium		2 x lithium CR2450R, 3V	2 x lithium CR2450R, 3V
Low voltage alert	2.5V +/-5% @ 25°C		2.2V +/-5% @ 25°C	2.2V +/-5% @ 25°C
Life expectancy	2 years		2 years	2 years
Standards				
Security grade	2	2	2	2
Environmental class	II	II	II	II
IP rating	-	-	-	-
EN certifications	EN50131-1:2006+A3:2020, EN50131-2-6:2008, EN50130-5:2011, EN5050131-5-3:2017, PD6662:2017		EN50130-4:2011+A1:2014, EN55032:2015+A11:2020 Class B, EN50130-4:2011+A1:2014	EN50131-2-8: 2016, EN 50131-1:2006+A3:2020, EN50131-5-3:2017
Electrical conformity	CE, UKCA		CE, UKCA	CE, UKCA
Warranty	2 years		2 years	2 years

Safety Sensors



Enforcer Two-way Wireless Safety Sensors

Protect both the property and its occupants with smoke, carbon monoxide (CO), heat and water leak sensors; raising the alarm to avoid potential disasters.

Partcode	SMOKE-WE2 (2nd Generation)	CO-WE2 (2nd Generation)	HEAT-WE	WL-WE
				
Sensor types				
Water leak sensor with 1m cable included	x	x	x	✓
Smoke detector	✓	x	x	x
Carbon monoxide detector	x	✓	x	x
Heat detector	x	x	✓	x
Specification features				
Button sensor test	✓	✓	✓	x
LED sensor test	✓	✓	✓	x
Front and rear tamper protection	✓	✓	✓	✓
3V Lithium battery included	1 x CR123A	1 x CR123A	1 x CR123A	1 x CR2
Signal Strength Indicators (SSI)	✓	✓	✓	✓
RF battery life - years (typical usage)	2	2	2	2
Sensor battery life - years	10	10	10	x
Standards	EN14604:2005 +AC:2008	EN50291- 1:2010+A1:2012	-	x

HUD/MED-WE

Wireless Hold-up/Medical Device

Conforming to BS 8243: 2010+A1: 2014, the HUD/MED-WE enables users to discreetly and conveniently signal for help, it's that simple.



for more information



Partcode	HUD/MED-WE
Technical specifications	
Button action	Hold-up (PA) or Medical (depending on the programming)
Button configuration	Pressed and held for 2 seconds
Hold-up function	✓
Indication	LEDs (Red, Green, Amber)
Transmission method	Fully encrypted rolling code
Code combinations	4294967295
Battery type	CR1/3N
Battery voltage	3V
Operating temperature	-10°C to +40°C
Dimensions (W x H x D)	30 x 72 x 20mm
Compatible with	Enforcer EURO (using the wireless expander)

Now compatible with UR2-WE





SPEAKER/SOUNDER-WE

Mimicking the tones of the control panel*

The SPEAKER/SOUNDER-WE replicates the chime, entry/exit, alarm, fire and even PA tones of the control panel to keep the user completely aware of any system activity while they're on-site. Distribute the sound evenly across the property to grab the attention and deliver total security with total awareness.

A bright courtesy light for complete reassurance

The in-built bright courtesy light of the SPEAKER/SOUNDER-WE will provide visual indication of system activity; illuminating the entrance as the user enters/exits, strobing in the event of an alarm activation, slow flashing for a chime and illuminating constantly as a safety light in the event of a fire. This can also be useful for deaf or hard of hearing users.

Lighting a path if the power fails

In the event of a mains power fail, the SPEAKER/SOUNDER-WE's bright courtesy light will illuminate for up to 30 minutes. So, in the event of a power outage the SPEAKER/SOUNDER-WE will provide a comforting light for the user; resetting back to normal operation as soon as the power is restored. Don't leave users in the dark.

Easy installer setup

The SPEAKER/SOUNDER-WE is easy to set up and configure, but it can also be adjusted at a later stage by the user should their preferences change. Volumes can be set in five increments and the bright courtesy light can even be activated or deactivated to suit. It's completely configurable.

Faster installation, less invasion, upsell opportunities and the same superior security with two-way wireless technology:

- **No wires, no fuss**

Fully wireless means there is no need to run wiring by lifting floorboards or moving furniture; saving time and money. Simply plug the SPEAKER/SOUNDER-WE into a mains plug socket and you're good to go.

- **One-Push-To-Learn**

A feature in all Enforcer wireless devices that means learning them onto the system can be done in seconds. A simple one-button learning feature for easy installation.

Please note: In the event of a mains fail the bright courtesy light will illuminate.

*Compatible with Enforcer V11 and EURO-ZEM32-WE v4.03.052

Warning: The activity of SPEAKER/SOUNDER-WE's bright courtesy light in the event of strobe and flashing may not be suitable for people with photosensitive epilepsy.

Partcode	SPEAKER/SOUNDER-WE
SAP code	361301848
Specifications features	
Alarm	✓
Chime	✓
Entry/exit tones	✓
Personal attack tones	✓
Adjustable volume	✓
Safety light**	✓
Rechargeable backup battery	✓
LED indications	Blue, red and green
Electrical specifications	
Power supply	230VAC ±5%, 50Hz
Operating current	~40mA @ 230VAC
Transmission frequency	868MHz FM transceiver narrow band
Transmission method and range	Fully encrypted rolling code, 300m
Backup battery type	3.7V 250mAh, lithium-ion (non replaceable)
Other details	
Casing	3mm polycarbonate
Operating temperature	-10 to 40°C
Weight	135g
Dimensions	64 x 100 x 65mm
Certifications	
Environmental class	II



for more information

Deltabell WE/E/Plus

Backlit Outdoor Siren



for more information

Visual and audible deterrent

The Deltabell Plus is a fully backlit outdoor siren that will create an effective visual alarm on any property when an alarm occurs, as well as produce a distinctive audible warning.

Status LEDs

The status LEDs flash alternately to indicate the live operation of the siren. These can also be disabled if required.

Sabotage protection

In case of any sabotage attempts, the Deltabell Plus has front and rear tamper protection.

All around protection

The electronic components on the printed circuit board are protected by a fully sealed unit with a rubber gasket; providing added protection in harsh environments. So, fit with reassurance that the Deltabell Plus will sound in the event of an alarm activation.

Partcode	DELTABELL-WE	DELTABELL-E	DELTABELL-PLUS
Key features			
Sound output	101dB	104dB	104dB
Number of piezos	1	1	1
Strobe LED	✓	✓	✓
Engineer hold-off	✓	✓	✓
Comfort LED	✓	✓	✓
Illuminated cover	x	x	✓
Front and rear tamper protection	✓	✓	✓
Power supply	3V/5A Lithium battery	9-16V	9-16V
Signal Strength Indicators (SSI)	✓	n/a	n/a
Battery life (typical usage)	2	backup battery	backup battery
Certifications			
EN50131	Grade 2	Grade 2 & 3	Grade 2 & 3
Environmental class	IV	IV	IV

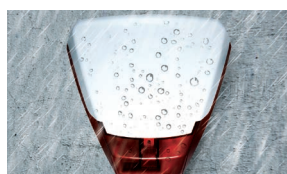
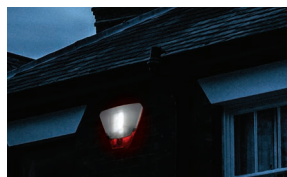

Deltabell X

With Optional Lightbox



	DELTABELL-X	DELTABELL-X +DELTAX-LIGHT
Key features		
Sound output	104dB	104dB
Number of piezos	2	2
Strobe LED	✓	✓
Engineer hold-off	✓	✓
Comfort LED	✓	✓
Illuminated cover	x	✓
Front and rear tamper protection	✓	✓
Power supply	9-16V	9-16V
Signal Strength Indicators (SSI)	n/a	n/a
Battery life (typical usage)	backup battery	backup battery
Certifications		
EN50131	Grade 2 & 3	Grade 2 & 3
Environmental class	IV	IV



for more information

Visual and audible deterrent

The Deltabell X with optional lightbox provides a superior visual and audible deterrent day or night. The lightbox provides superior lighting to the front of the siren. When an alarm is triggered the lightbox will strobe while the twin piezo sirens produce a high decibel warning.

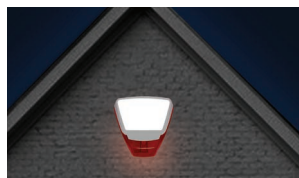

Status LEDs

The status LEDs flash alternately to indicate the live operation of the siren. These can also be disabled.



Beat the burglar with tamper protection

This ensures that maximum security is maintained against accidental or malicious tampering of the system. Any sabotage attempts from the front or back, or power supply cut off will result in an activation independently from the control panel.



Protected whatever the weather

The electronic components on the printed circuit board are protected by a fully sealed unit with a rubber gasket. This provides added protection in harsh environments and gives peace of mind that the Deltabell X will always sound in the event of an alarm activation.



Deltabell Accessories

Wired and Wireless Outdoor Siren

Providing an attractive around-the-clock visual deterrent, the Deltabell range offers multiple colour, screen printing, piezo and backlight options, as well as enhanced installation features, to provide the perfect siren solution.



DELTA-BDB	DELTA-BDR	DELTA-BDW	DELTA-BDBK	DELTA-BDA	DELTA-BDG
Deltabell base, blue	Deltabell base, red	Deltabell base, white	Deltabell base, black	Deltabell base, amber	Deltabell base, green
DELTA-CB	DELTA-CR	DELTA-CW	DELTA-CBK	DELTA-CY	DELTA-CC
Deltabell cover, blue	Deltabell cover, red	Deltabell cover, white	Deltabell cover, black	Deltabell cover, yellow	Deltabell cover, chrome
DELTA/MOD-E	DELTA/MOD-PLUS	DELTA/MOD-WE	DELTA/MOD-X	DELTA/LIGHT	
Wired Deltabell module with single piezo	Wired Deltabell module with single piezo and illumination	Wireless Deltabell-WE module including the battery pack	Wired Deltabell X module with twin piezo siren	Backlight module for use with Deltabell X	

Twin Alert

Wired Indoor Siren

The Twin Alert combines both a speaker and siren in a single unit. This eliminates the need for two separate products situated in different locations; optimising installation efficiency.

Features:

- Tamper protection
- Compatible with any panel featuring a speaker output
- 100dB loudness
- Engineer hold-off



Partcode	FP10800
Strobe and sound features	
Sound output	100dB
Number of piezos	1
Engineer hold-off	x
Tamper protection included	✓
For indoor use	✓
Warranty (years)	2
Certifications	
EN50131	Grade 2
Environmental class	II



for more information

Accessories

Batteries

BATT-ENF8XAA	BATT-ESI	BATT-CR34615D	CR123A VARTA BATTERY	BATT-CR2	BATT-CR1/3N	BATT-CR/KF1	BATT-KF1215	CR2450R
								
9.6V, 2Ah battery	3V, 5Ah Lithium battery	3V, 11Ah Lithium battery	CR123A, 3V Lithium battery	CR2, 3V Lithium battery	3V powercap battery	3V battery (Polarised Pins)	3V Lithium powercap battery	3V Lithium button cell battery

Panel

ENFORCER 1

Keypad

LEDRKP/WHITE-WE 1

Sirens

DELTABELL-WE 2

DELTABELL-WE MK(I) 1

Detectors

XDL12TT-WE 2

KX10DP-WE 1

KX10DT-WE 2

KX12DTP-WE 2

KX12DQ-WE 1

KX15DC-WE 1

KX25LR-WE 1

MC1 MINI-WE 1

MC1 /SHOCK-WE 1

MCEXTERNAL-WE 1

MCNANO-WE 1

NANO /SHOCK-WE 2

ASSET-WE 2

CARDEFENDER-WE 2

SMOKE-WE (2nd Generation) 1

HEAT-WE 1

CO-WE (2nd Generation) 1

MC2-WE 1

WL-WE 1

Keyfobs

KF4-WE MK I* 1

KEYFOB MK II* 1

KEYFOB-WE 1







HUD/MED-WE 1

*Superseded by KEYFOB-WE.



Accessories

Brackets, Lenses, Plastics and Cables







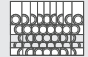



KX Detectors

KXBRACKET-C	KXBRACKET-W	KX15-VL	KX18-LC	KX30-LR	KX-TAMPER
					
10 x Ceiling bracket for the KX range	10 x Wall bracket for the KX range	3 x Replacement volumetric lens for KX 15m	3 x Replacement curtain lens for KX 18m	3 x Replacement long range lens for KX 30m	10 x Tamper kit for the KX brackets

XD Detectors



XD-WALLBRACKET	XD-45D ADAPTER	XD-FIXEDBRACKET	XD-LENS5
			
Adjustable wall bracket +/- 45° with anti-tamper protection. This allows for better volumetric coverage.	45° adapter for use with the XD-WALLBRACKET. This allows the XD detectors to be positioned at 90°.	Wall bracket with rear tamper. This can be used to create 30m coverage.	Volumetric lens for the XDH. Installation 2.4m, 85°, 10m detection distance. (3pcs)

Contacts

MC1MINI-SPACER	MC1S/SPACER	MC-BROWN-KIT	MC1/SHOCKBR-KIT
			
White spacer* kit for the MC1MINI-WE	White spacer* kit for the MC1/SHOCK-WE	Brown plastics kit for MC1-WE, MC2-WE, RS1-WE, RS2-WE.	Brown 10 x fronts and 10 x backs for MC1/SHOCK-WE
MC1MINI-SPACERBR	MC1S/SPACERB	MC1MINIBR-KIT	MAGNETBR-KIT
			
Brown spacer* kit for the MC1MINI-WE	Brown spacer* kit for the MC1/SHOCKBR-WE	Brown 10 x fronts and 10 x backs for MC1MINI-WE	Brown 20 x magnet plastics kit
MC1MINIGR-KIT	MC1/SHOCKGR-KIT	 <p>* The spacer enables the magnetic contact to be installed on an uneven or misaligned door or window frame.</p>	
			
Anthracite 5 x fronts and 5 x backs for MC1MINI-WE and 5 x magnet plastics	Anthracite 5 x fronts and 5 x backs for MC1/SHOCK-WE and 5 x magnet plastics		

HUD/MED Brackets

Included in the pack

WALL BRACKET	BELT CLIP
	

MCNANO-WE

Plastics

MCNANO/GR-KIT	MCNANO/BR-KIT
	

AndroidTablet Mounting Brackets

Wall brackets



Accessories

Brackets, Lenses, Plastics and Cables

NANO/SHOCK-WE

Plastics

NANO/SHOCKGR-KIT

NANO/SHOCKBK-KIT

NANO/SHOCKBR-KIT



Programming Cables

RS232



RS232 programming cable

RS232USB



USB to RS232 converter cable

Keypad and Tags

EUR-PTAG



5 x Proximity tags for the Enforcer and EURO

EUR-ETAG



5 x Proximity tags for the Enforcer and EURO

LCD-FLUSHBOX



Flushmount adapter for the EURO-LCDP/W

LCD-CASING/CHROME



Shiny chrome casing for the EURO LCDPZ/SCHROME

LCD-CASING/BCHROME



Brushed chrome casing for the EURO LCDPZ/SCHROME

LCD-CASING/BLACK



Black casing for the EURO LCDPZ/SCHROME

Communication Leads

Comms Ribbon

EUR-114





Follow us on LinkedIn  @pyronixltd 

www.facebook.com/pyronix  @pyronix 

Pyronix Limited, Secure House, Braithwell Way, Hellaby, Rotherham, South Yorkshire, S66 8QY, UK

T: +44 (0)1709 700 100 **E:** sales@pyronix.com **W:** www.pyronix.com